

REVISION TABLE

| REV | DESCRIPTION | DATE | BY |
|-----|-----------------|------------|-----|
| - | INITIAL RELEASE | 09/11/2015 | RJM |

COMPONENT LIST

| ITEM | DESCRIPTION | ITEM QTY | PART NUMBER | STOCK NUMBER | REV |
|------|--|----------|---------------------------|-----------------|-----|
| 1 | GLAND PACKING HOUSING - FIXED - 40 SHAFT - STD | 1 | 7000-0003 | | - |
| 2 | GLAND PACKING RETAINER BOSS - 40 SHAFT | 1 | 7000-0012 | 100dia RND - 30 | A |
| 3 | HEX HEAD SCREW | 6 | HEX HEAD SCREW - M10 x 20 | | |
| 4 | HEX HEAD SCREW | 2 | HEX HEAD SCREW - M10 x 40 | | |
| 5 | HEX HEAD SCREW | 2 | HEX HEAD SCREW - M12 x 50 | | |
| 6 | PLAIN WASHER | 8 | PLAIN WASHER - M10 | | |
| 7 | PLAIN WASHER | 2 | PLAIN WASHER - M12 | | - |
| 8 | GLAND PACKING | 1 | PP-001391 | | - |
| 9 | 40mm 2-BOLT FLANGE BEARING | 1 | PP000003-05 | UCFT208 | - |
| 10 | SPRING WASHER | 8 | SPRING WASHER - M10 | | |
| 11 | SPRING WASHER | 2 | SPRING WASHER - M12 | | |

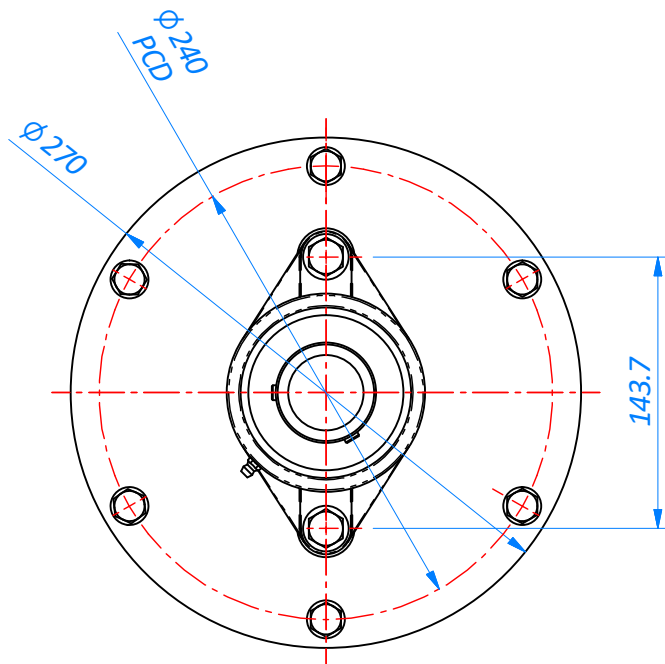

SCALE - (1 : 4)

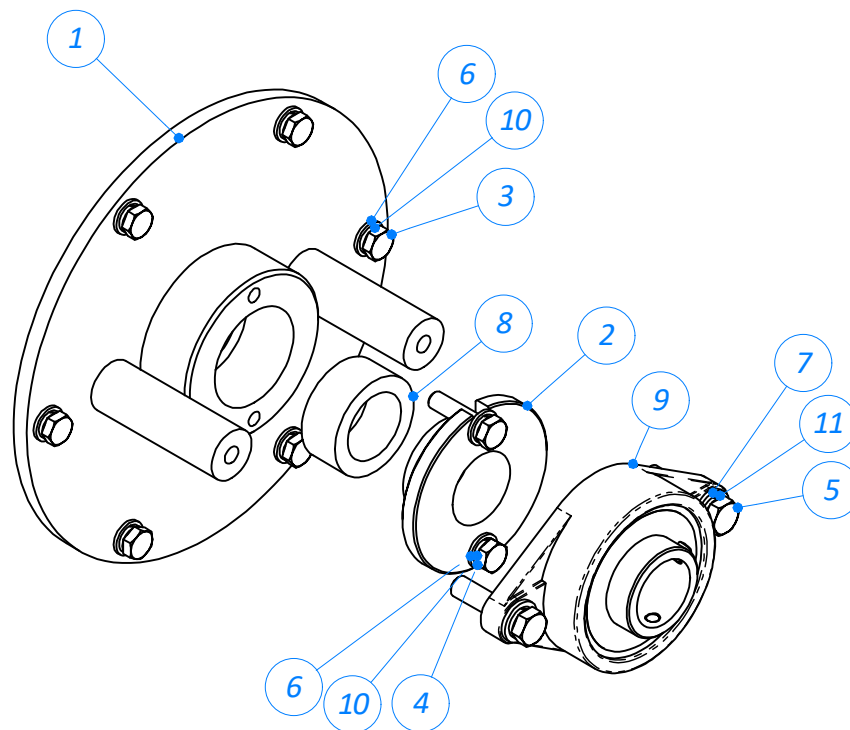
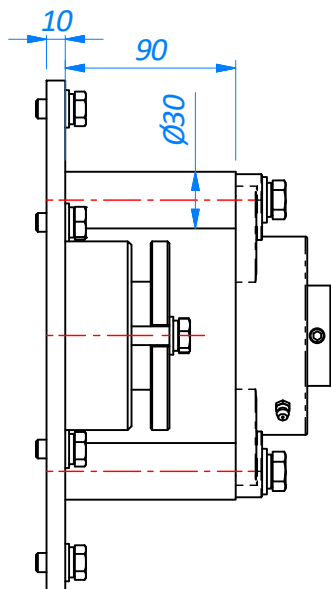

A Member of the Haith Tickhill Group of companies
 Cow House Lane, Armthorpe, Doncaster, South Yorkshire, England DN3 3EE
 Tel: +44 (0)1302 831911 Fax +44 (0)1302 300 173 sales@haith.co.uk

UNLESS OTHERWISE SPECIFIED TOLERANCES ON DIMENSIONS ARE:-
 Whole number/one metre length ± 1
 One Decimal Places ± 0.5
 Two Decimal Places ± 0.1

DRAWING TITLE

GLAND PACKING HOUSING ASSY - FIXED - 40 SHAFT - STD

STOCK NUMBER

MACHINE

MASS

9.712 kg

GLAND HOUSINGS

This drawing is the property and copyright of the Haith Tickhill Group and is supplied on the express condition that it is neither copied nor passed to any third party without prior permission in writing.

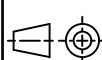

SCALE PER VIEW **A4**
 SHEET NUMBER
 1 of 1

CREATED 27/05/2015
 CHKD

RJM

DRAWING No

7000-0002

REVISION

-

REVISION TABLE

| REV | DESCRIPTION | DATE | BY |
|-----|-----------------|------------|-----|
| - | INITIAL RELEASE | 09/11/2015 | RJM |

COMPONENT LIST

| ITEM | DESCRIPTION | ITEM QTY | PART NUMBER | STOCK NUMBER | REV |
|------|--|----------|---------------------------|-----------------|-----|
| 1 | GLAND PACKING RETAINER BOSS - 40 SHAFT | 1 | 7000-0012 | 100dia RND - 30 | A |
| 2 | GLAND PACKING HOUSING - ADJ - 40 SHAFT - STD | 1 | 7000-0014 | | - |
| 3 | HEX HEAD SCREW | 6 | HEX HEAD SCREW - M10 x 20 | | |
| 4 | HEX HEAD SCREW | 2 | HEX HEAD SCREW - M10 x 40 | | |
| 5 | HEX HEAD SCREW | 2 | HEX HEAD SCREW - M12 x 50 | | |
| 6 | PLAIN WASHER | 8 | PLAIN WASHER - M10 | | |
| 7 | PLAIN WASHER | 2 | PLAIN WASHER - M12 | | - |
| 8 | GLAND PACKING | 1 | PP-001391 | | - |
| 9 | 40mm 2-BOLT FLANGE BEARING | 1 | PP000003-05 | UCFT208 | - |
| 10 | SPRING WASHER | 8 | SPRING WASHER - M10 | | |
| 11 | SPRING WASHER | 2 | SPRING WASHER - M12 | | |

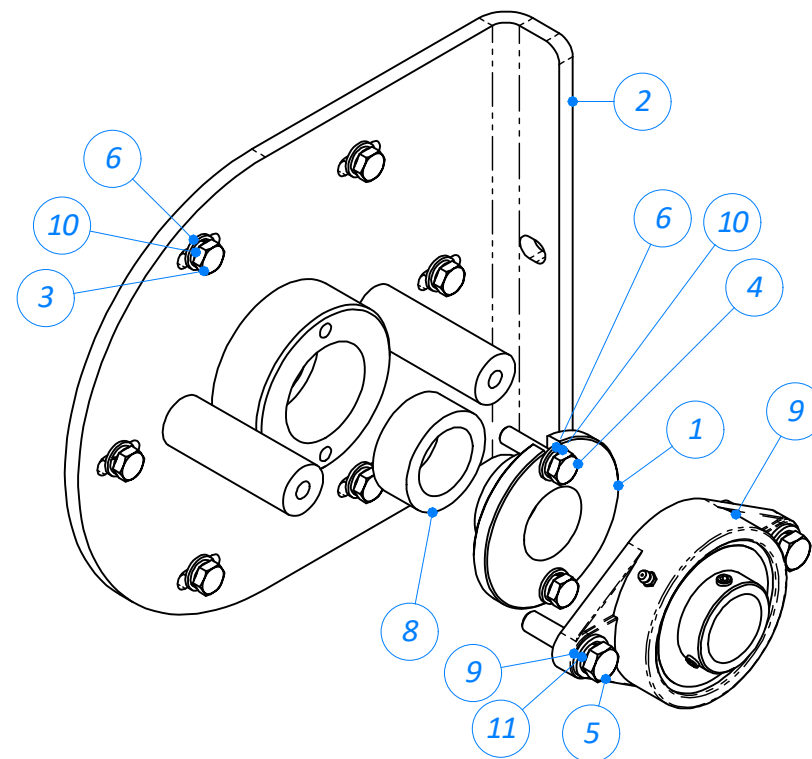
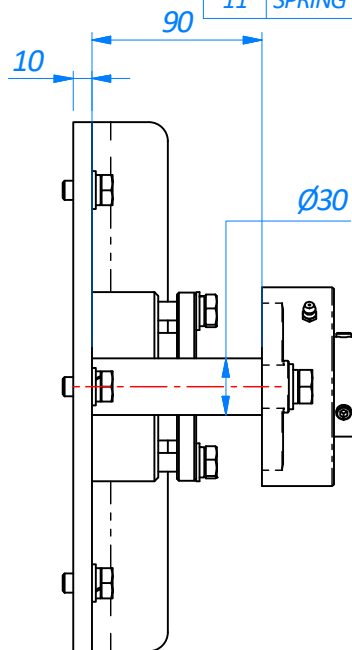
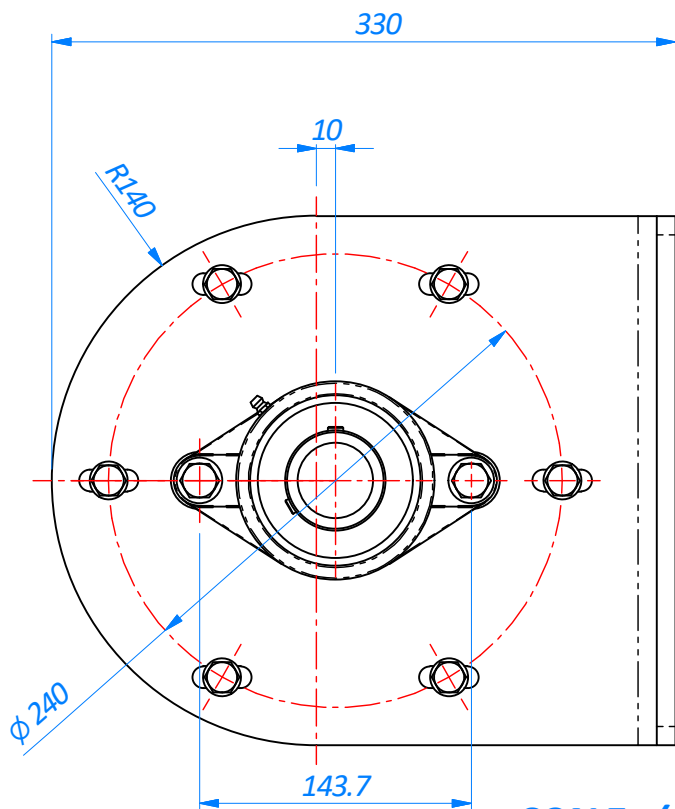

SCALE - (1 : 4)



A Member of the **Haith Tickhill Group** of companies
 Cow House Lane, Armthorpe, Doncaster, South Yorkshire, England DN3 3EE
 Tel: +44 (0)1302 831911 Fax +44 (0)1302 300 173 sales@haith.co.uk

UNLESS OTHERWISE SPECIFIED TOLERANCES ON DIMENSIONS ARE:-
 Whole number/one metre length ± 1
 One Decimal Places ± 0.5
 Two Decimal Places ± 0.1

DRAWING TITLE

GLAND PACKING HOUSING ASSY - ADJ - 40 SHAFT - STD

STOCK NUMBER

MACHINE

MASS

12.414 kg

GLAND HOUSINGS

This drawing is the property and copyright of the Haith Tickhill Group and is supplied on the express condition that it is neither copied nor passed to any third party without prior permission in writing.

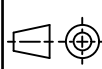

SCALE **A4**
 PER VIEW
 SHEET NUMBER
 1 of 1

CREATED **27/05/2015**
 CHKD

RJM

DRAWING No

7000-0013

REVISION

-

REVISION TABLE

| REV | DESCRIPTION | DATE | BY |
|-----|-----------------|------------|-----|
| - | INITIAL RELEASE | 26/05/2016 | RJM |

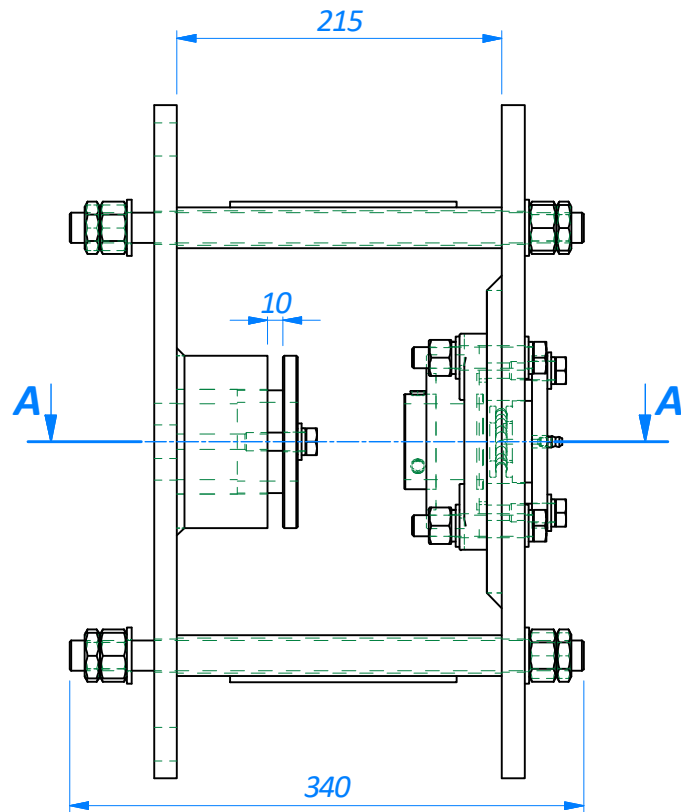
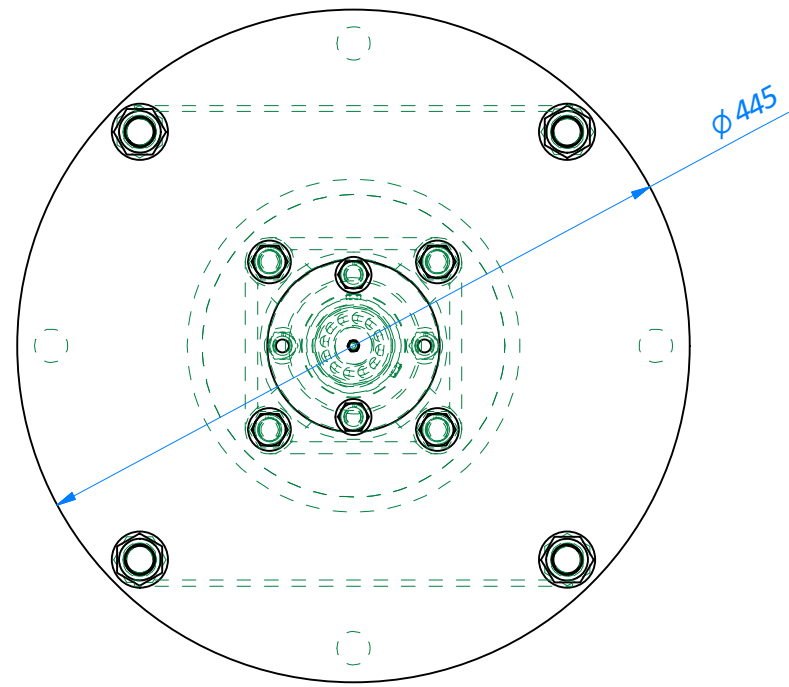

SCALE - (1 : 5)

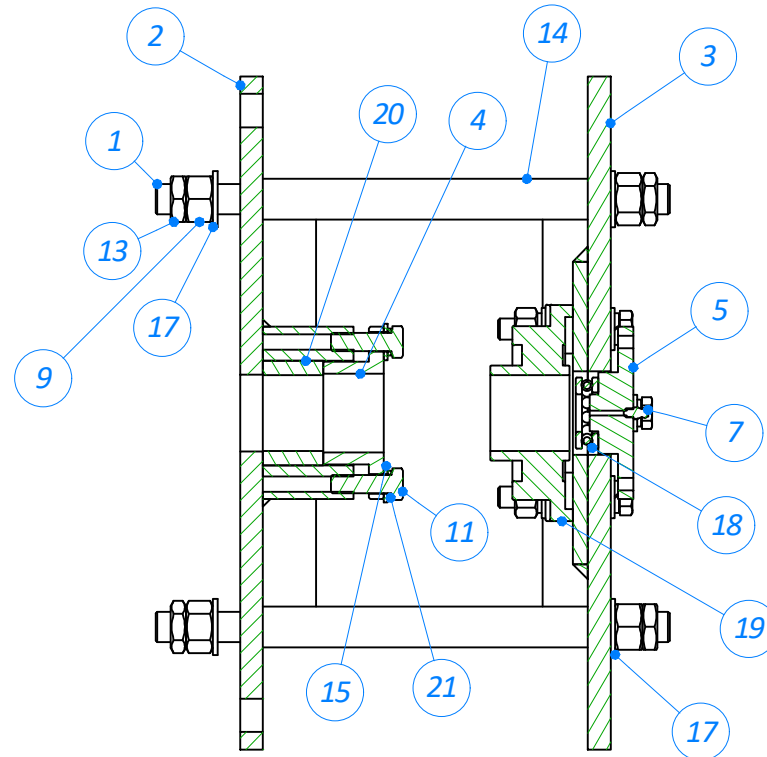

SECTION A-A
SCALE - (1 : 5)

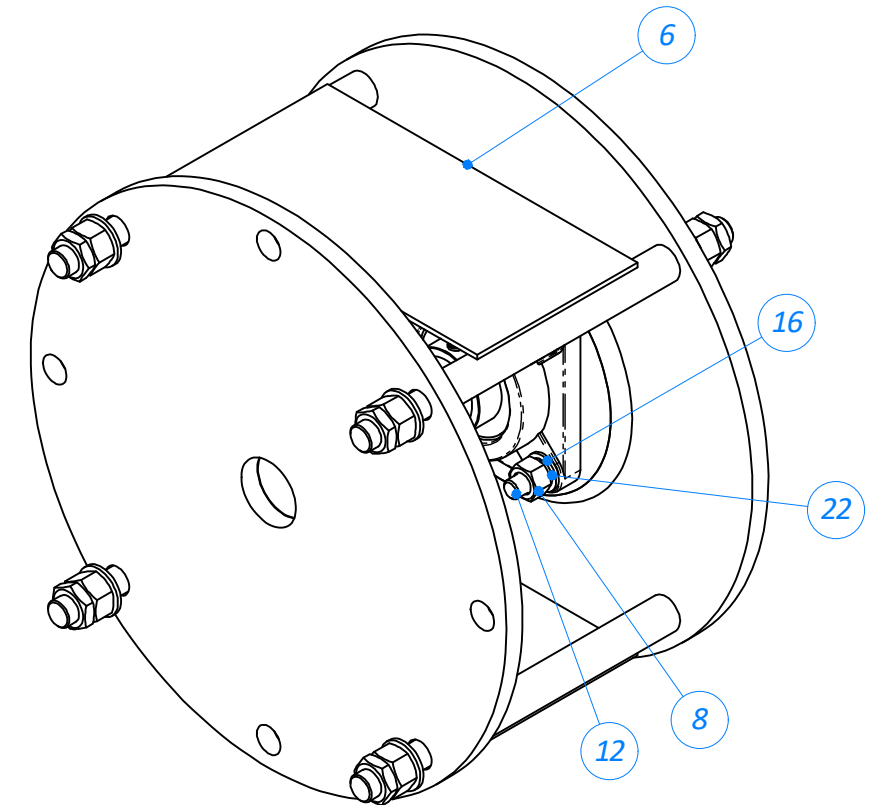
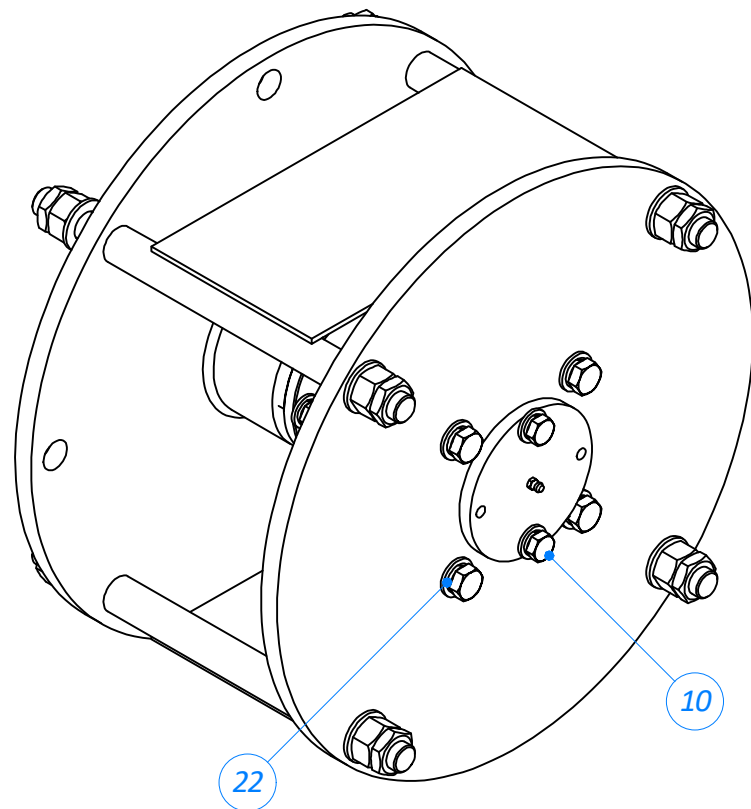

COMPONENT LIST

| ITEM | DESCRIPTION | QTY | PART No | STOCK No | REV |
|------|--|-----|---------------------------|---------------|-----|
| 1 | THREADED BAR - M20x340 | 4 | 7000-0019-20-340 | M20 x 340 | - |
| 2 | AUGER INNER END FLANGE-300-50 | 1 | 7000-0032 | | - |
| 3 | AUGER TAIL END OUER FLANGE | 1 | 7000-0038 | | - |
| 4 | AUGER GLAND PACKING CLAMP BOSS - 50dia | 1 | 7000-0039 | 115dia RND | - |
| 5 | AUGER TAIL END THRUST BOSS | 1 | 7000-0040 | 115dia RND | - |
| 6 | AUGER FLANGE SPACER BRACE | 2 | 7000-0128 | 4 THK | - |
| 7 | Grease Nipple | 1 | DIN 71412 - M6 | | - |
| 8 | HEX FULL NUT | 4 | HEX FULL NUT - M16 | | - |
| 9 | HEX FULL NUT | 8 | HEX FULL NUT - M20 | | - |
| 10 | HEX HEAD SCREW | 2 | HEX HEAD SCREW - M12 x 30 | | - |
| 11 | HEX HEAD SCREW | 2 | HEX HEAD SCREW - M12 x 40 | | - |
| 12 | HEX HEAD SCREW | 4 | HEX HEAD SCREW - M14 x 80 | | - |
| 13 | HEX THIN NUT | 8 | HEX THIN NUT - M20 | | - |
| 14 | TUBE | 4 | ISO 4200 - 26.9x2 - 215 | 26.9x2 - TUBE | - |
| 15 | PLAIN WASHER | 4 | PLAIN WASHER - M12 | | - |
| 16 | PLAIN WASHER | 8 | PLAIN WASHER - M14 | | - |
| 17 | PLAIN WASHER | 8 | PLAIN WASHER - M20 | | - |
| 18 | THRUST RACE | 1 | PP-000205 | RHP - 51205 | - |
| 19 | 4-BOLT SQUARE FLANGED BEARING - 50mm | 1 | PP-000291-07 | UCF210 | - |
| 20 | GLAND PACKING MEDIA | 1 | PP-001394 | | - |
| 21 | SPRING WASHER | 4 | SPRING WASHER - M12 | | - |
| 22 | SPRING WASHER | 8 | SPRING WASHER - M14 | | - |



A Member of the **Haith Tickhill Group** of companies
Cow House Lane, Armthorpe, Doncaster, South Yorkshire, England DN3 3EE
Tel: +44 (0)1302 831911 Fax +44 (0)1302 300 173 sales@haith.co.uk

This drawing is the property and copyright of the Haith Tickhill Group and is supplied on the express condition that it is neither copied nor passed to any third party without prior permission in writing.

UNLESS OTHERWISE SPECIFIED TOLERANCES ON DIMENSIONS ARE:-
Whole number/one metre length ± 1
One Decimal Places ± 0.5
Two Decimal Places ± 0.1

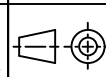

SCALE PER VIEW **A3**
SHEET NUMBER 1 of 1

DRAWING TITLE

AUGER TAIL END ASSEMBLY - 300 - 50

STOCK NUMBER

MACHINE

MASS

55.379 kg

CREATED

26/05/2016

RJM

DRAWING No

HAITH COMMON PARTS

7000-0058

REVISION

-

| REVISION TABLE | | | |
|----------------|-----------------|------------|-----|
| REV | DESCRIPTION | DATE | BY |
| - | INITIAL RELEASE | 26/05/2016 | RJM |

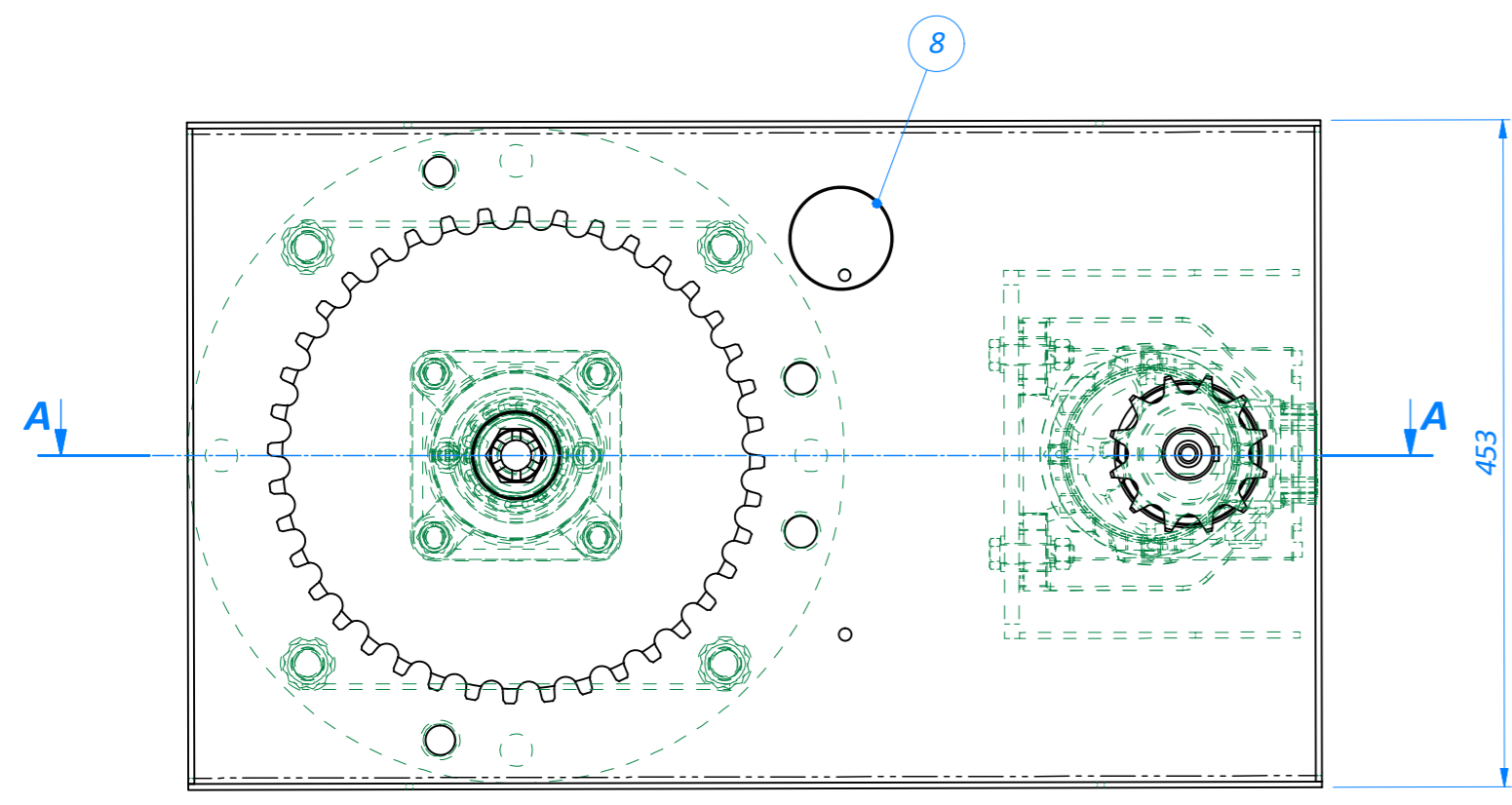

| ITEM | DESCRIPTION | QTY | COMPONENT LIST | | | REV |
|------|---|-----|---------------------------|---|--|-----|
| | | | PART No | STOCK No | | |
| 1 | THREADED BAR - M20x340 | 4 | 7000-0019-20-340 | M20 x 340 | | - |
| 2 | AUGER INNER END FLANGE-300-50 | 1 | 7000-0032 | | | - |
| 3 | AUGER GLAND PACKING CLAMP BOSS - 50dia | 1 | 7000-0039 | 115dia RND | | - |
| 4 | AUGER DRIVE END OUTER FLANGE - 300 - 50 | 1 | 7000-0041 | 15 THK | | - |
| 5 | AUGER DRIVE END THRUST BOSS - 50dia | 1 | 7000-0042 | 90dia RND | | - |
| 6 | AUGER DRIVE FRAME - MOTOVARIO | 1 | 7000-0048 | | | A |
| 7 | AUGER DRIVE CHAIN GUARD | 1 | 7000-0050 | 1.5 THK | | - |
| 8 | AUGER CHAIN TENSIONER (NYLON) | 1 | 7000-0051 | 70 dia NYLON | | - |
| 9 | AUGER DRIVEN SPROCKET | 1 | 7000-0055 | | | - |
| 10 | AUGER DRIVE SPROCKET - 1" x 12 - 35dia | 1 | 7000-0057 | | | - |
| 11 | AUGER SPROCKET RETAINING WASHER | 1 | 7000-0070 | | | - |
| 12 | AUGER FLANGE SPACER BRACE | 2 | 7000-0128 | 4 THK | | - |
| 13 | Grease Nipple | 1 | DIN 71412 - M6 | | | - |
| 14 | HEX FULL NUT | 4 | HEX FULL NUT - M12 | | | - |
| 15 | HEX FULL NUT | 4 | HEX FULL NUT - M14 | | | - |
| 16 | HEX FULL NUT | 8 | HEX FULL NUT - M20 | | | - |
| 17 | HEX HEAD SCREW | 2 | HEX HEAD SCREW - M12 x 40 | | | - |
| 18 | HEX HEAD SCREW | 4 | HEX HEAD SCREW - M12 x 50 | | | - |
| 19 | HEX HEAD SCREW | 4 | HEX HEAD SCREW - M14 x 60 | | | - |
| 20 | HEX THIN NUT | 8 | HEX THIN NUT - M20 | | | - |
| 21 | TUBE | 4 | ISO 4200 - 26.9x2 - 215 | 26.9x2 - TUBE | | - |
| 22 | PLAIN WASHER | 10 | PLAIN WASHER - M12 | | | - |
| 23 | PLAIN WASHER | 8 | PLAIN WASHER - M14 | | | - |
| 24 | PLAIN WASHER | 8 | PLAIN WASHER - M20 | | | - |
| 25 | THRUST RACE | 1 | PP-000203 | RHP - 51111 | | - |
| 26 | 4-BOLT SQUARE FLANGED BEARING - 50mm | 1 | PP-000291-07 | UCF210 | | - |
| 27 | GLAND PACKING MEDIA | 1 | PP-001394 | | | - |
| 28 | CASTLE NUT - M24 | 1 | PP-001462 | | | - |
| 29 | TRANSMISSION CHAIN | 1 | PP-001712 | 1" SIMPLEX - 64 LINKS | | - |
| 30 | GEARED MOTOR | 1 | PP-002533 | MOTOVARIO - CH053, 216.4:1, 4 POLE, 3ph, 50Hz | | - |
| 31 | SPRING WASHER | 6 | SPRING WASHER - M12 | | | - |
| 32 | SPRING WASHER | 8 | SPRING WASHER - M14 | | | - |

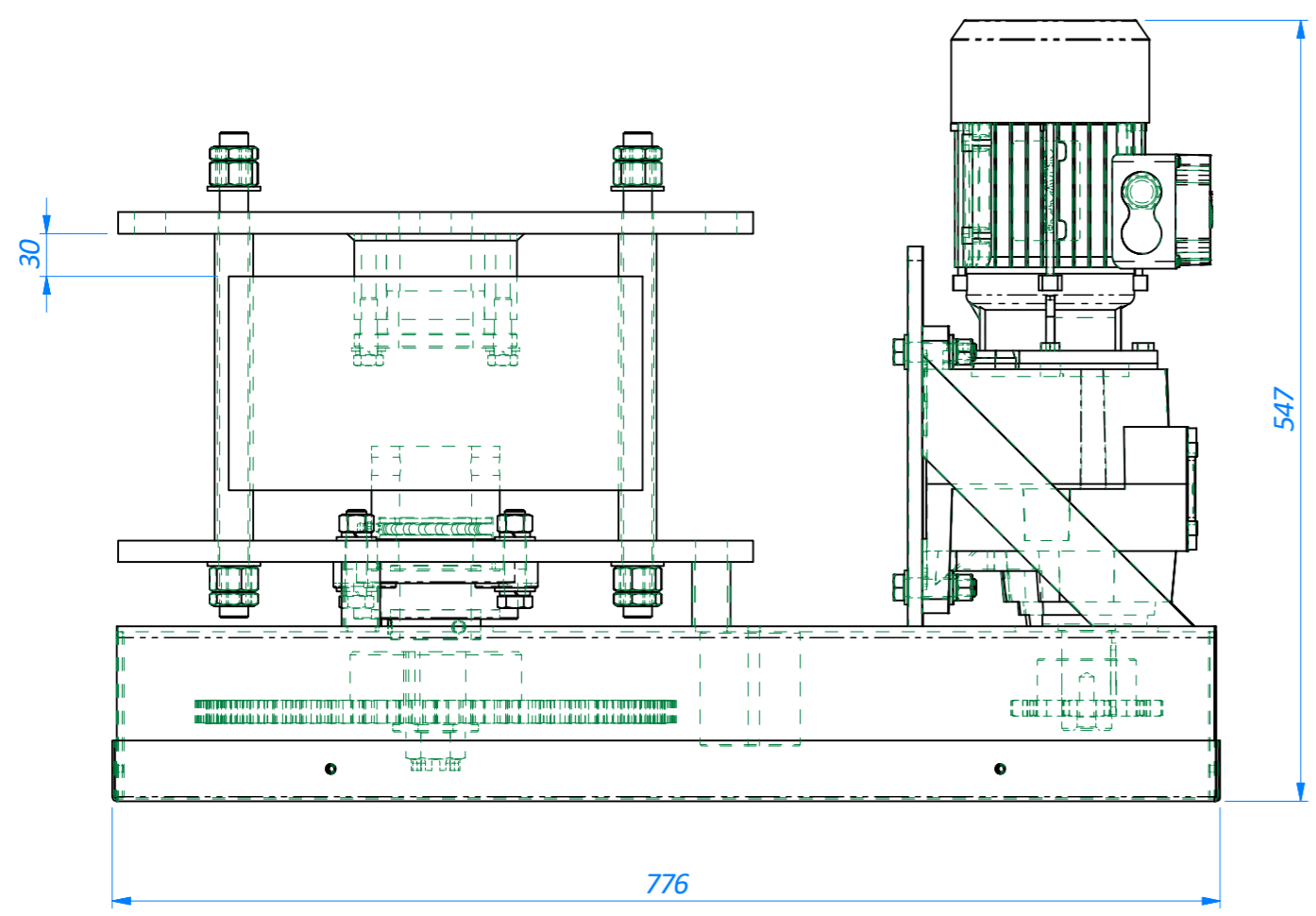

SCALE - (1 : 5)

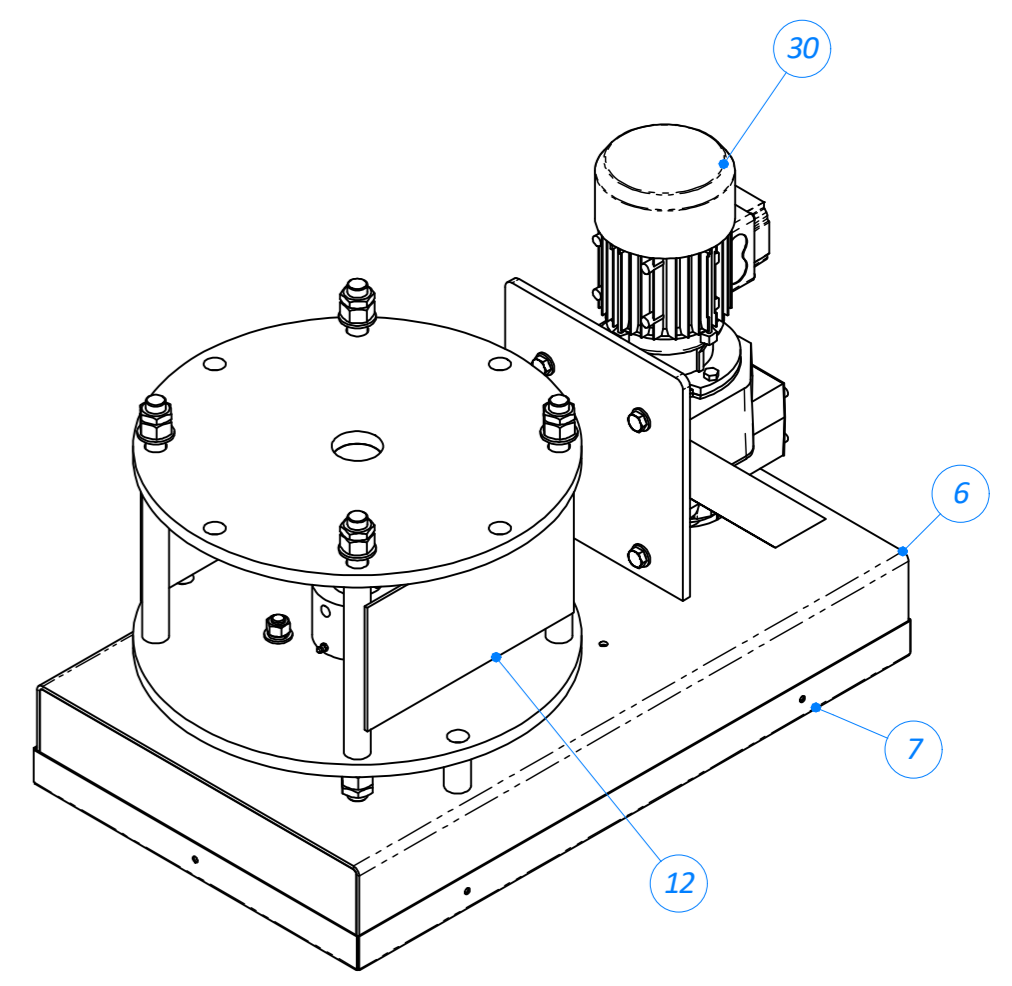
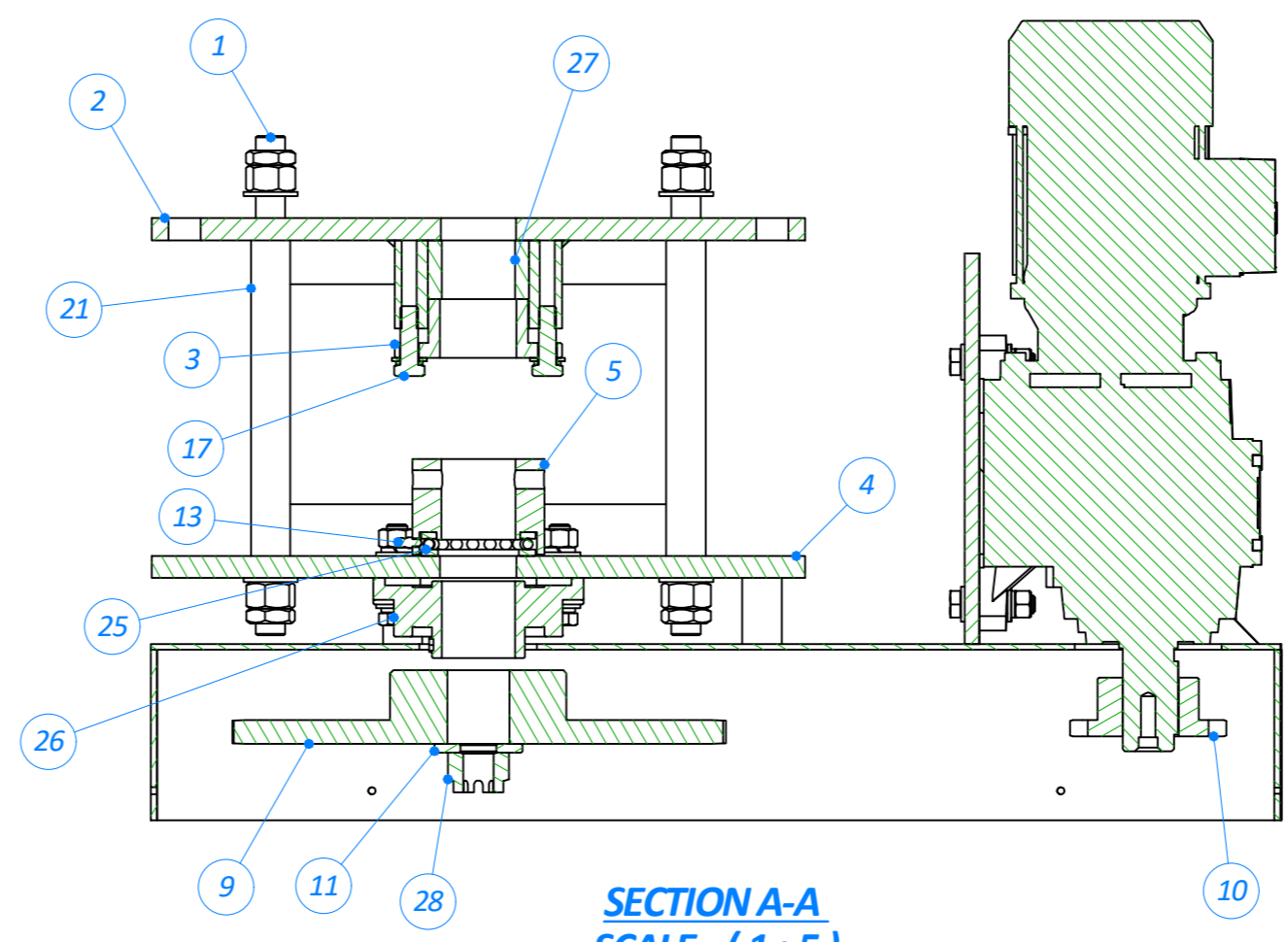

| | | | | | |
|---|---|---|-----------------------------------|---|--------------------------|
| <p>A Member of the Haith Tickhill Group of companies Cow House Lane, Armthorpe, Doncaster, South Yorkshire, England DN3 3EE Tel: +44 (0)1302 831911 Fax: +44 (0)1302 300 173 sales@haith.co.uk</p> | <p>UNLESS OTHERWISE SPECIFIED TOLERANCES ON DIMENSIONS ARE:-</p> <p>Whole number/one metre length ± 1</p> <p>One Decimal Places ± 0.5</p> <p>Two Decimal Places ± 0.1</p> | DRAWING TITLE | | <p>STOCK NUMBER</p> <p>MASS</p> <p>106.587 kg</p> | <p>MACHINE</p> |
| | | <p>AUGER DRIVE ASSEMBLY - MOTOVARIO</p> <p>WASHER AUGER PARTS</p> | | | |
| <p>This drawing is the property and copyright of the Haith Tickhill Group and is supplied on the express condition that it is neither copied nor passed to any third party without prior permission in writing.</p> | | <p>SCALE</p> <p>PER VIEW</p> <p>A2</p> | <p>SHEET NUMBER</p> <p>1 of 1</p> | <p>DRAWING No</p> <p>7000-0061</p> | <p>REVISION</p> <p>-</p> |

| REV | DESCRIPTION | DATE | BY |
|-----|---|------------|-----|
| | INITIAL RELEASE | 18/06/2017 | |
| A | CHANGED ALGER POSITION | 05/07/2017 | RJM |
| B | CHANGED SLUDGE ELEVATOR BELT | 06/08/2017 | RJM |
| C | CHANGED STONE ELEVATOR DRIVE TO HANIP 110 | 07/08/2017 | RJM |
| D | CHANGED STONE ELEVATOR DRIVEN ROLLER | 26/01/2018 | RJM |
| E | CHANGED STONE ELEVATOR DRIVEN ROLLER | 31/01/2018 | RJM |

| | | COMPONENT LIST | | | |
|------|---|----------------|----------------|----------|-----|
| ITEM | DESCRIPTION | QTY | PART No | STOCK No | REV |
| 1 | DESTONER | 1 | 24141-003-0001 | | |
| 2 | BASE TANK ASSY | 1 | 24141-003-0002 | | A |
| 3 | STONE ELEVATOR ASSEMBLY - 750wdr/3600rs | 1 | 24141-003-0003 | | C |
| 4 | SLUDGE ELEVATOR ASSEMBLY | 1 | 24141-003-0004 | | A |
| 5 | DESTONER FRAMEWORK | 1 | 24141-003-0125 | | - |
| 6 | ISO NB U-BOLT | 2 | PP-001833-150 | | - |
| 7 | VIBRATORY SCREEN | 1 | PP-001839 | | - |

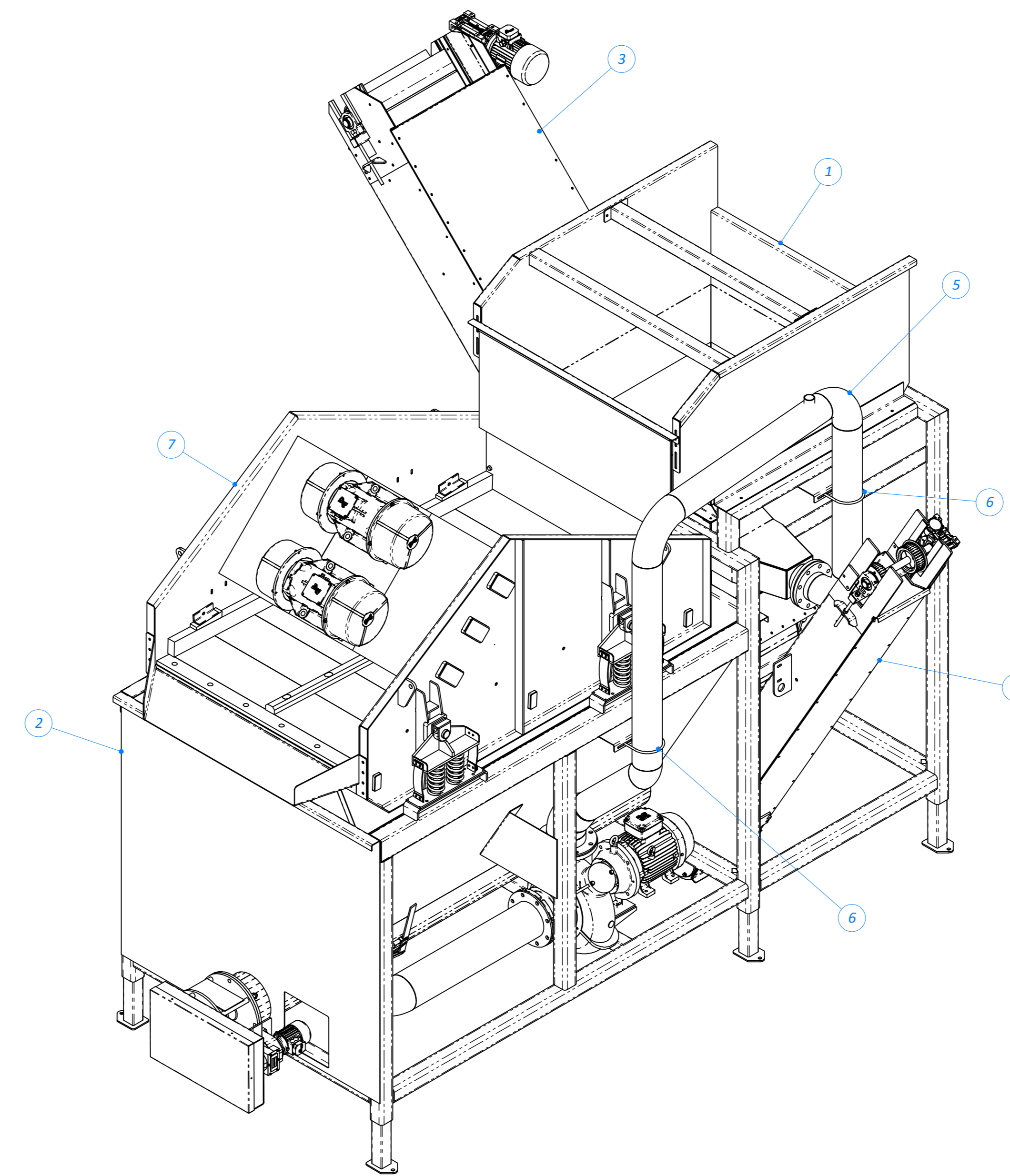
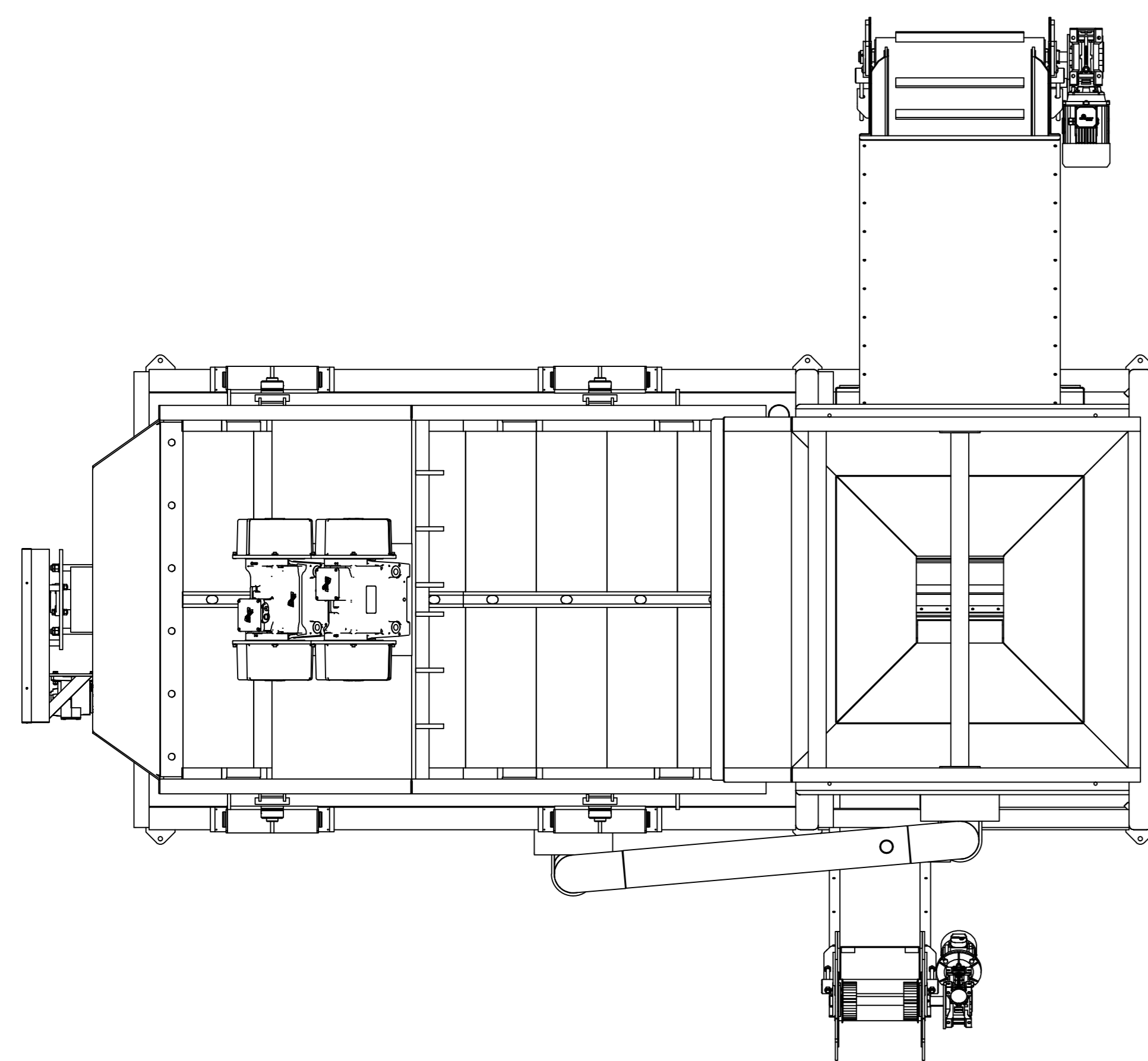
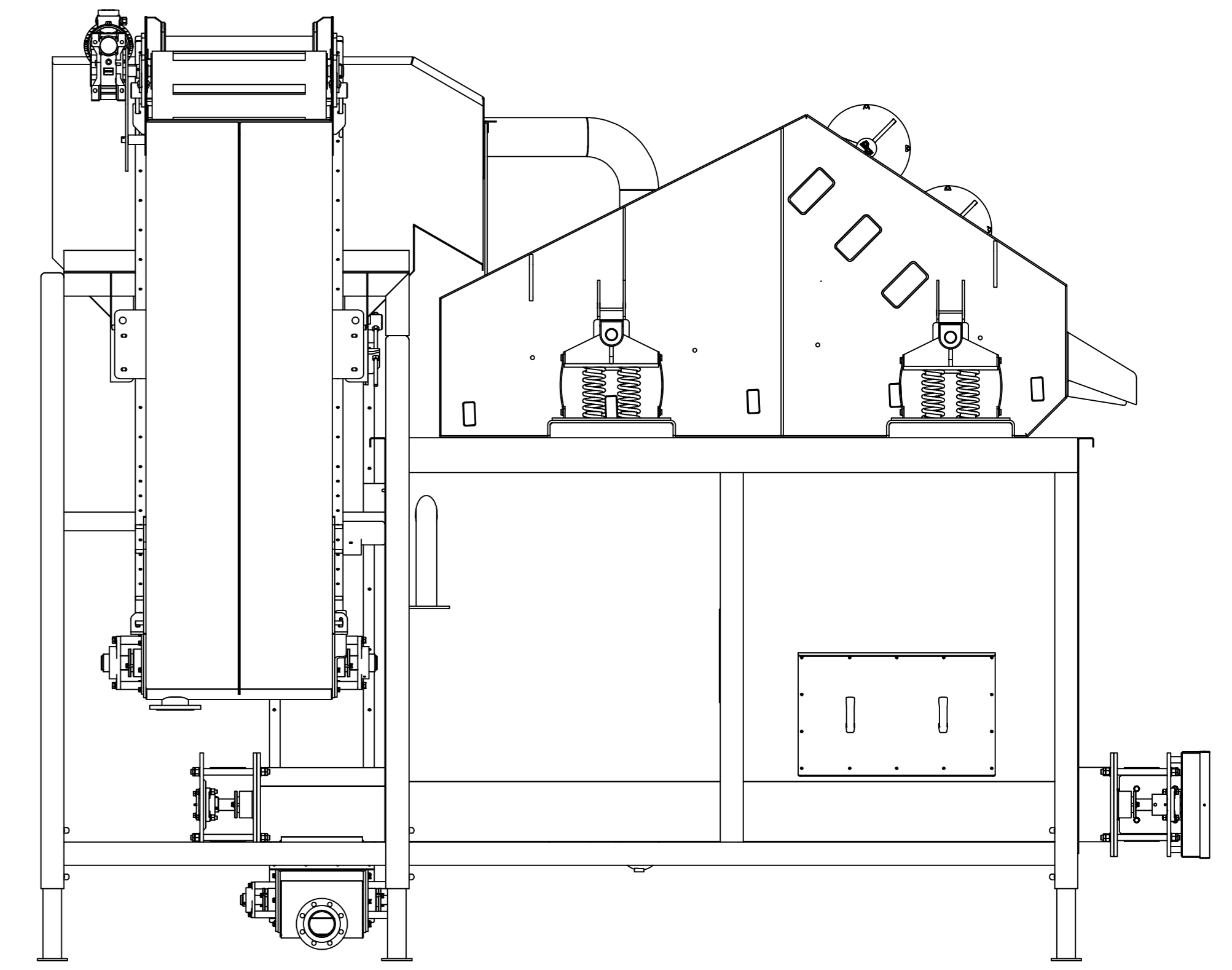
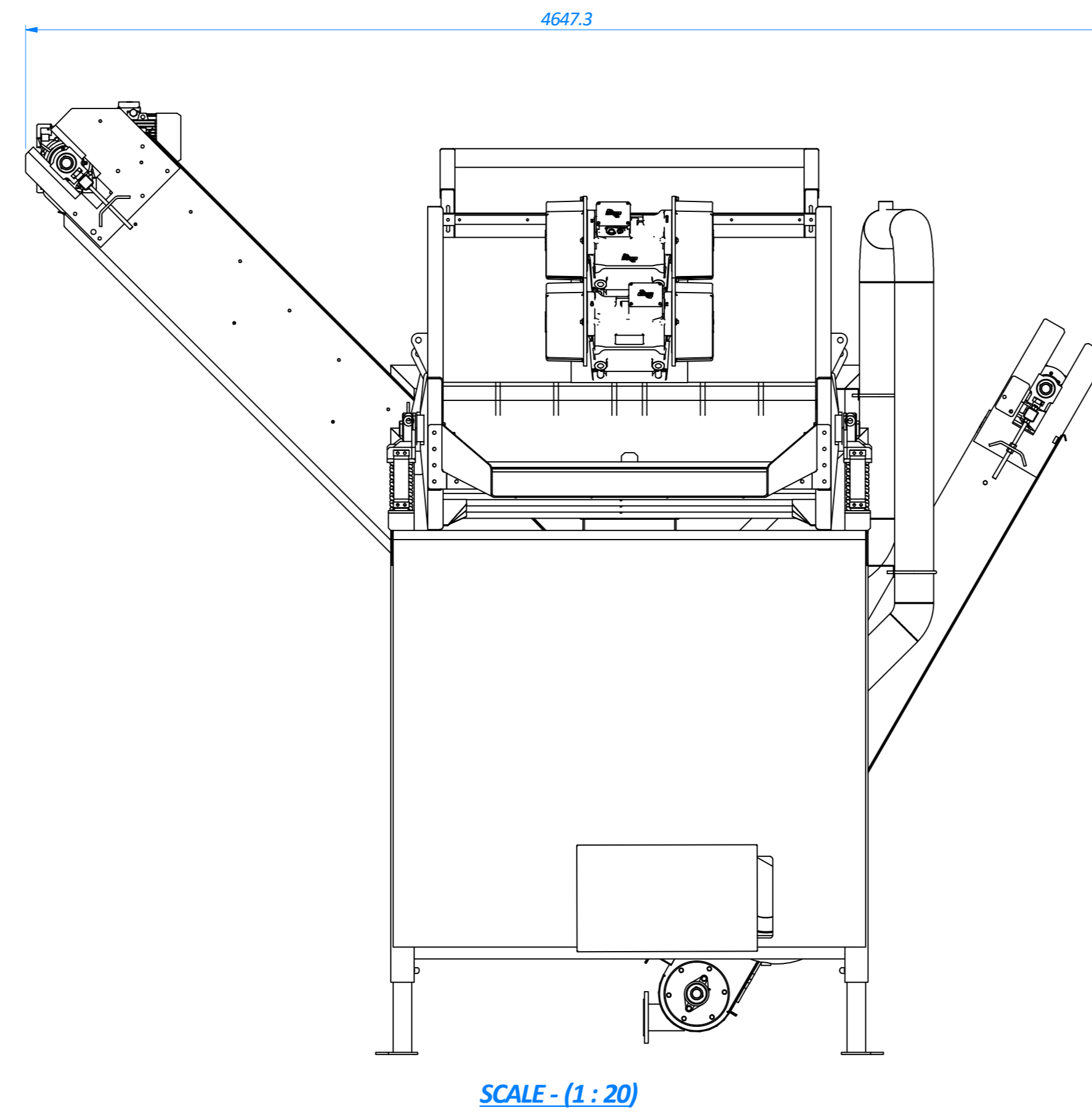
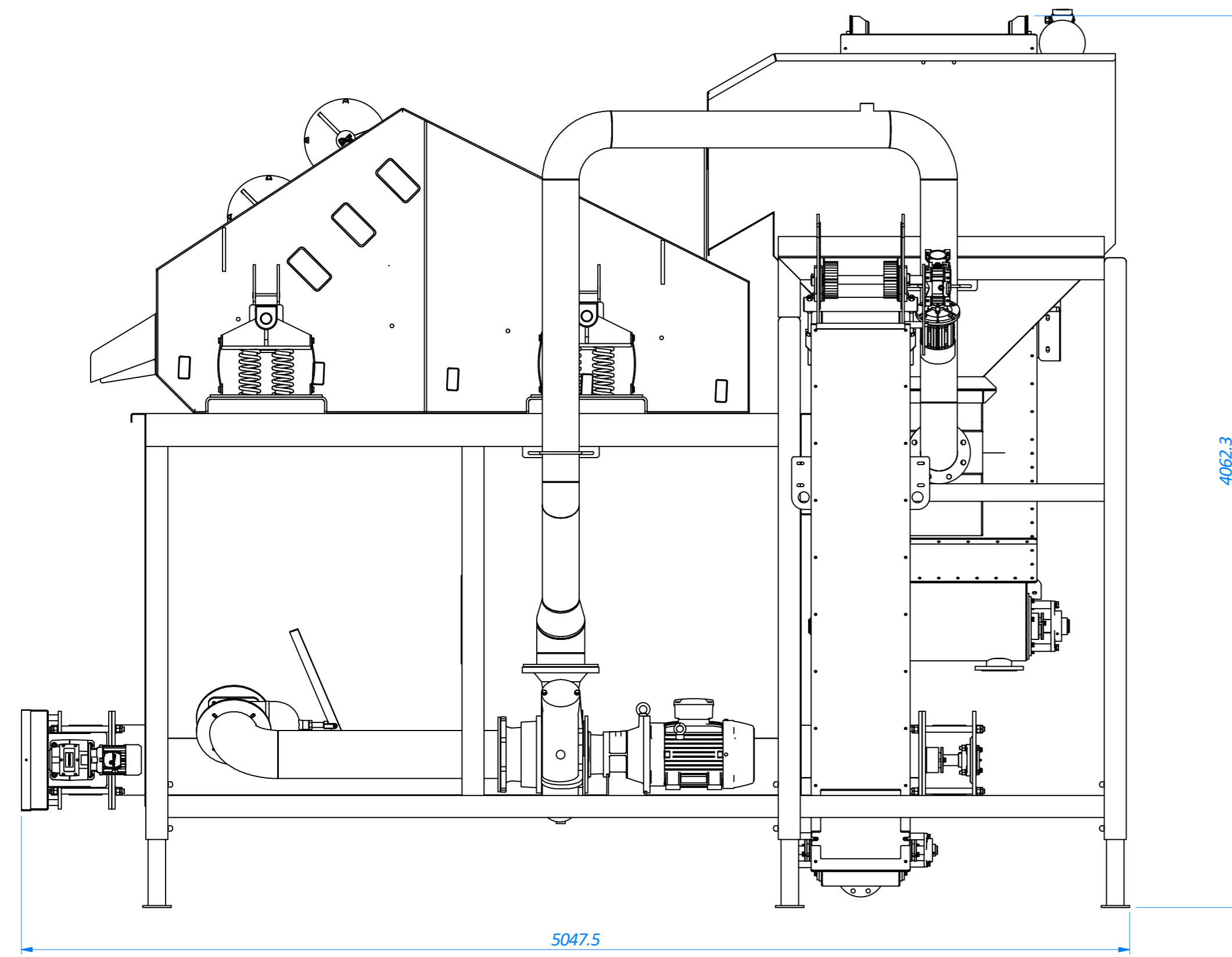

| | | |
|--|---|---|
| <p>A Member of the Hatch Group of Companies One House Lane, Waltham, Doncaster, South Yorkshire, England DN4 8SE Tel: +44 (0)1522 875111 Fax: +44 (0)1522 861713 enquiries@hatchgroup.com</p> <p>This drawing is the property and copyright of the Hatch Technol Group and is supplied on the express condition that its neither copied nor passed to any third party without prior permission in writing.</p> | <p>UNLESS OTHERWISE SPECIFIED TOLERANCES ON DIMENSIONS ARE:- mm: 0.1 mm: 0.05 mm: 0.1</p> | <p>PROJECT TITLE VIBRO-FLUME</p> |
| | <p>SCALE 4748.108 kg</p> | <p>PROJECT NO WARD RECYCLING</p> |
| | <p>DATE 18/06/2014</p> | <p>DESIGNER RJM</p> |
| | <p>1 of 1</p> | <p>24141-003 E</p> |

| REV TABLE | | | |
|-----------|------------------------------|------------|-----|
| REV | DESCRIPTION | DATE | BY |
| - | INITIAL RELEASE | 18/05/2017 | -- |
| A | CHANGED AUGER DRIVE POSITION | 04/07/2017 | RIM |

| | | COMPONENT LIST | | | |
|------|------------------------------------|----------------|----------------|---|-----|
| ITEM | DESCRIPTION | QTY | PART No | STOCK No | REV |
| 1 | AUGER | 1 | 24141-003-0016 | | - |
| 2 | INSPECTION DOOR PLATE | 1 | 24141-003-0133 | 4 THK | - |
| 3 | BASE TANK PIPING | 1 | 24141-003-0134 | | - |
| 4 | BASE TANK | 1 | 24141-003-0141 | | A |
| 5 | LEG INSERT 80x80x3 - 0800 | 6 | 7000-0026-0800 | | - |
| 6 | AUGER TAIL END ASSEMBLY - 300 - 50 | 1 | 7000-0058 | | - |
| 7 | AUGER DRIVE ASSEMBLY - MOTOVARIO | 1 | 7000-0061 | | A |
| 8 | DOOR HANDLE | 2 | PP-000150 | MOSS DIRECT (462251) | - |
| 9 | 8" KNIFE VALVE WITH HANDLE | 1 | PP-000890 | | - |
| 10 | PUMP | 1 | PP-003594 | HIROSTAL E08R-HLN2R+EFMLX-M160Q(LINED) INVERTER CONTROL | - |

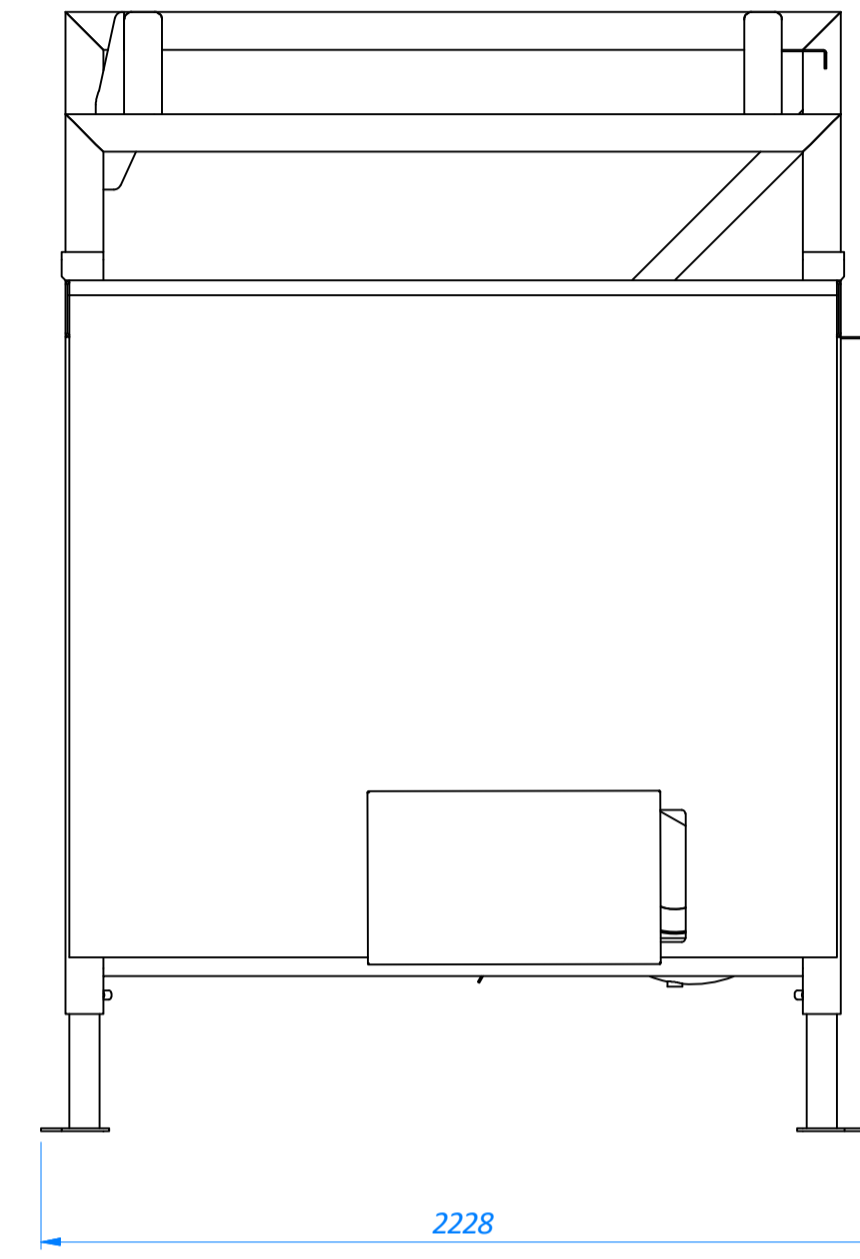
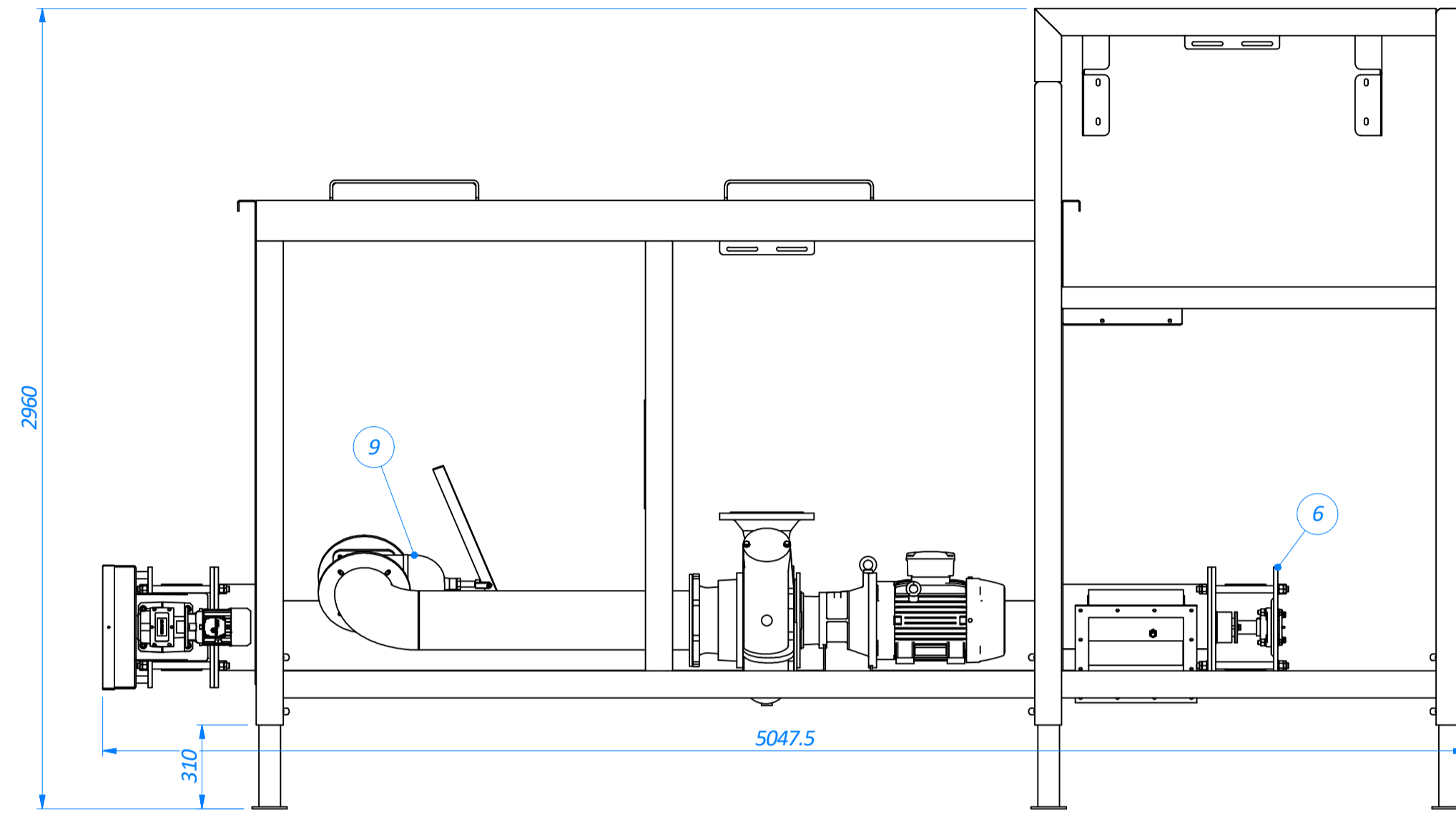

SCALE - (1 : 20)

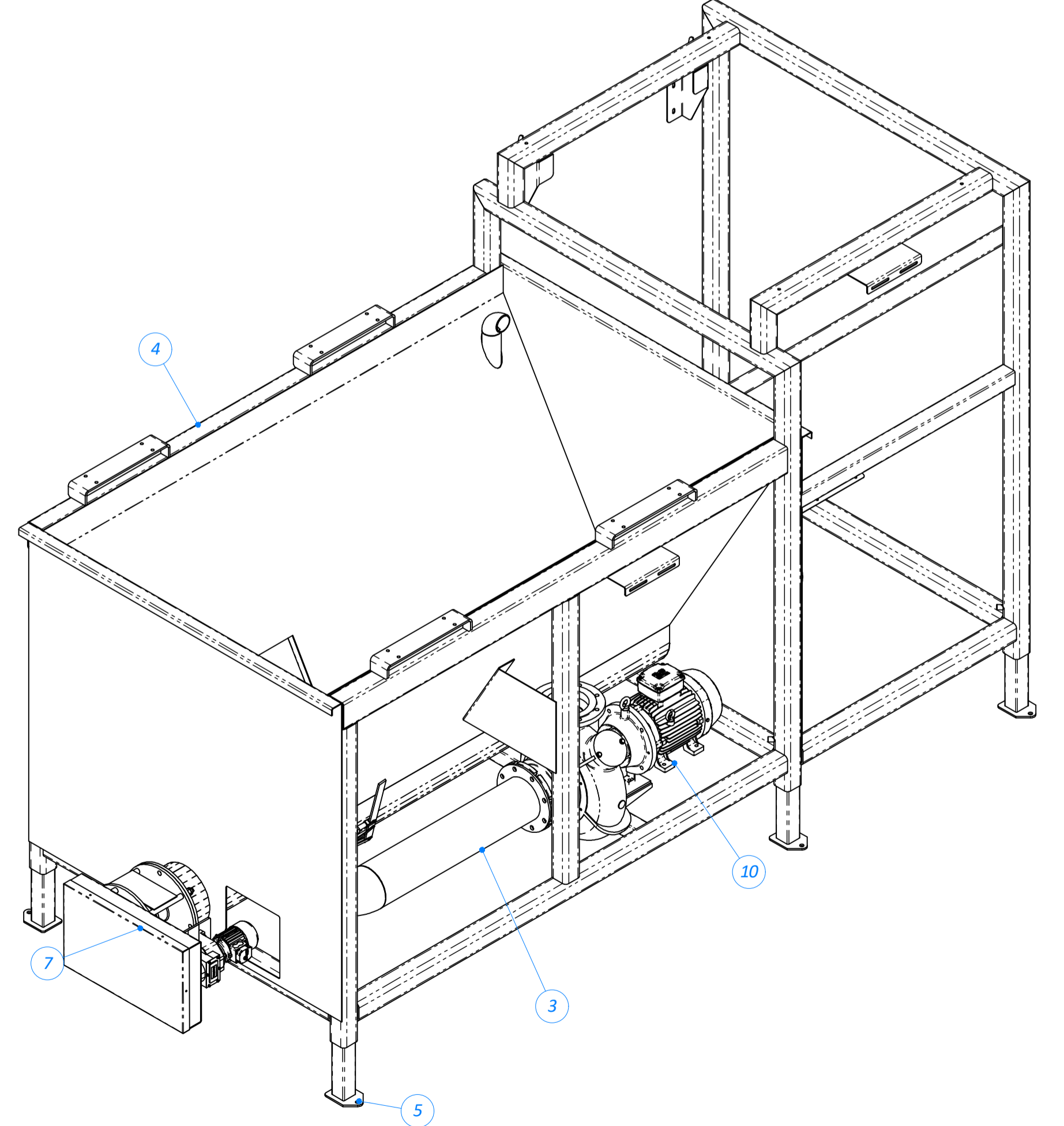
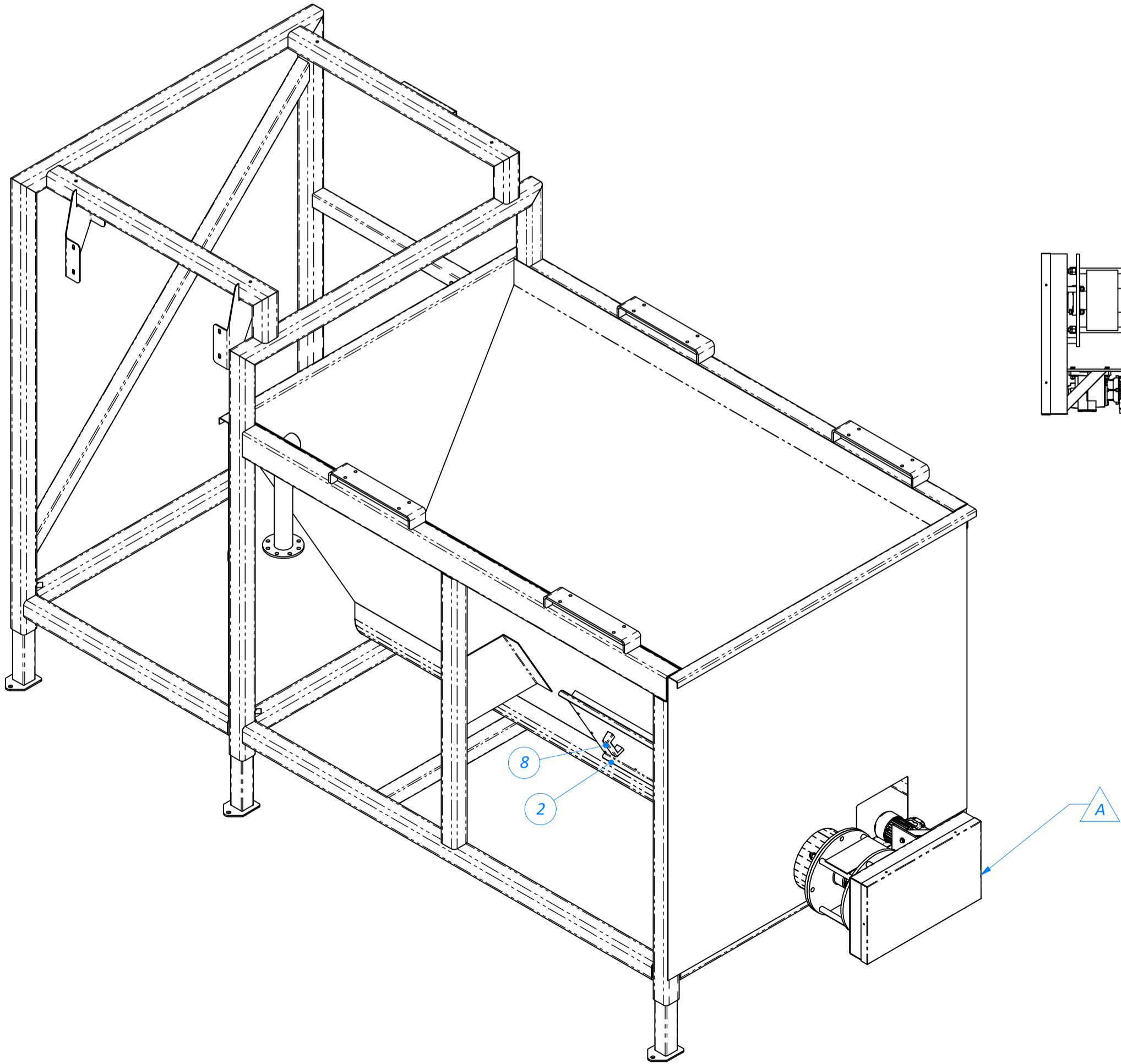
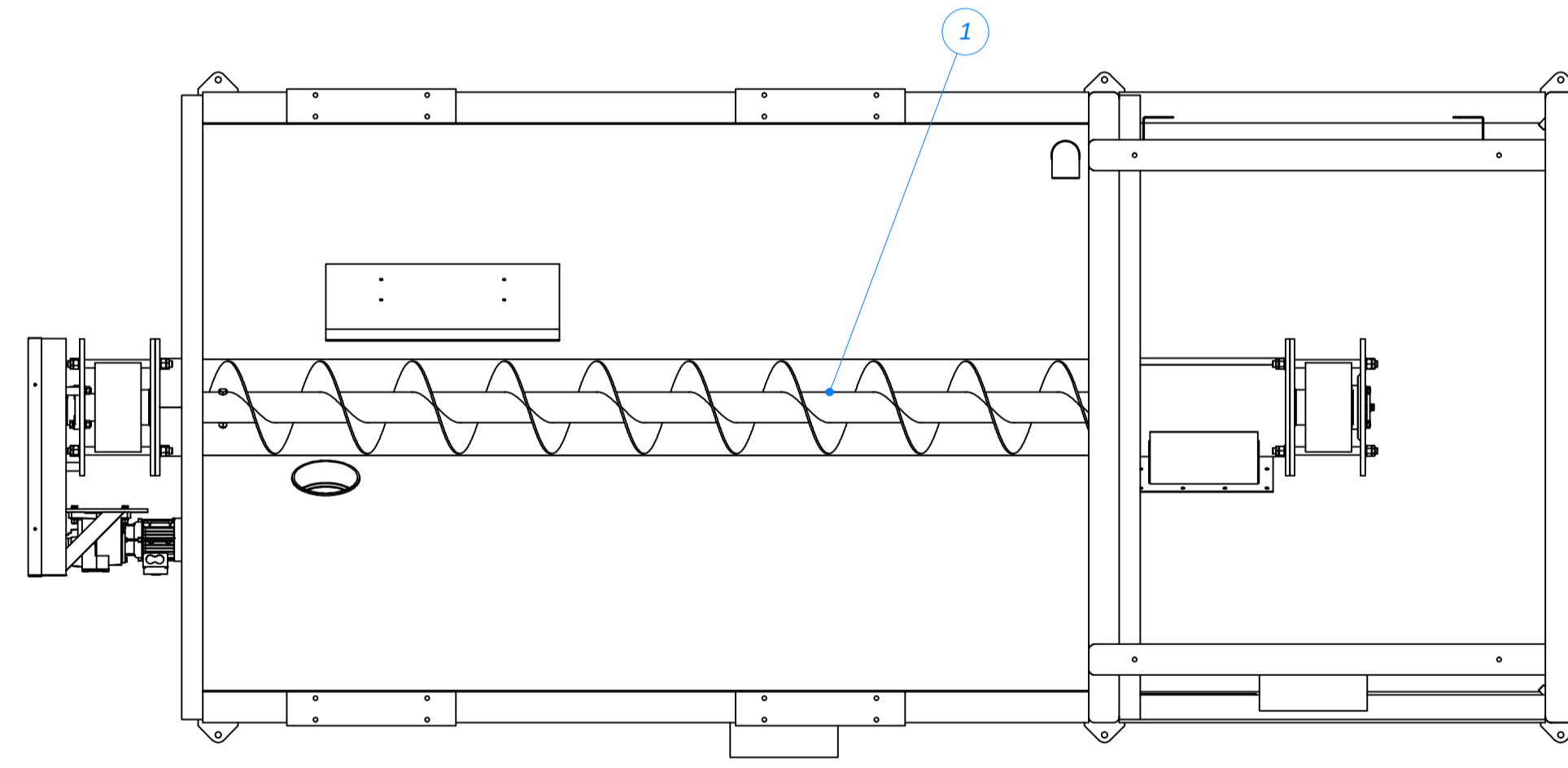

| | | |
|---|--|--|
| <p>A Member of the Haith Tackhill Group of companies One House Lane, Airedale, Doncaster, South Yorkshire, England DN3 3EE Tel: +44 (0)1302 831911 Fax: +44 (0)1302 300 173 sales@haith.co.uk</p> | <p>UNLESS OTHERWISE SPECIFIED TOLERANCES ON DIMENSIONS ARE:- Whole number/metre length # 1 One Decimal Places # 0.5 Two Decimal Places # 0.1</p> | <p>DRAWING TITLE BASE TANK ASSY</p> |
| | <p>STOCK NUMBER 2575.436 kg</p> | <p>SCALE 18/05/2017</p> |
| <p>This drawing is the property and copyright of the Haith Tackhill Group and is supplied on the express condition that it is neither copied nor passed to any third party without prior permission in writing.</p> | <p>PER VIEW A1 1 of 1</p> | <p>PROJECT NO 24141-003-0002</p> |

| REV | DESCRIPTION | DATE | BY |
|-----|---|------------|-----|
| | INITIAL RELEASE | 19/05/2017 | RJM |
| A | CHANGED DRIVE TO NMRVP 110 | 07/08/2017 | RJM |
| B | CHANGED DRIVEN ROLLER | 26/01/2018 | RJM |
| C | CHANGED DRIVEN SHAFT DIA AND GLAND PACKING HOUSINGS | 31/01/2018 | RJM |
| D | CHANGED DRIVE SHAFT DIA | 13/06/2018 | RJM |

| ITEM | DESCRIPTION | ITEM QTY | PART NUMBER | STOCK NUMBER | REVISION NUMBER |
|------|---|----------|------------------|--|-----------------|
| 1 | DEFLECTOR PLATE | 1 | 24141-003-0065 | 4 THK | - |
| 2 | BOLT ON DRIVE PLATE | 1 | 24141-003-0079 | | - |
| 3 | SKIRT - RH - 3600 | 1 | 24141-003-0088 | | - |
| 4 | SKIRT - LH - 3600 | 1 | 24141-003-0094 | | - |
| 5 | BOOT SEAL PLATE | 2 | 24141-003-0096 | 4 THK | - |
| 6 | ACCESS DOOR | 2 | 24141-003-0097 | 10 THK | - |
| 7 | ELEVATOR DRIVE ROLLER | 1 | 24141-003-0098 | | A |
| 8 | DRIVEN ROLLER | 1 | 24141-003-0102 | | B |
| 9 | SKIRT CLAMP - 3600 | 2 | 24141-003-0107 | | - |
| 10 | SKIRT RUBBER - 3600 | 2 | 24141-003-0108 | RUBBER - 10x60 | - |
| 11 | RUBBER SEAL | 2 | 24141-003-0109 | RUBBER - 10mm | - |
| 12 | SEAL CLAMP | 3 | 24141-003-0110 | | - |
| 13 | DRIVE BEARING ADJUSTER | 1 | 24141-003-0112 | | - |
| 14 | TORQUE ARM BOSS | 1 | 24141-003-0113 | 40 dia RND | - |
| 15 | TORQUE ARM - NMRVP 110 | 1 | 24141-003-0114 | 10 THK | A |
| 16 | ELEVATOR RUBBER SEAL | 1 | 24141-003-0115 | RUBBER - 10mm | - |
| 17 | ELEVATOR TOP - 3600crs | 1 | 24141-003-0117 | | - |
| 18 | ELEVATOR TROUGH - 3600crs | 1 | 24141-003-0118 | | - |
| 19 | REMOVABLE BELT SUPPORT - 3600crs | 1 | 24141-003-0119 | | - |
| 20 | REMOVABLE ACCESS LID | 1 | 24141-003-0125 | | - |
| 21 | GLAND PACKING HOUSING ASSY - FIXED - 60 SHAFT | 1 | 24141-003-0162 | | - |
| 22 | GLAND PACKING HOUSING ASSY - ADJ - 60 SHAFT | 1 | 24141-003-0163 | | - |
| 23 | THREADED BAR - M12x160 | 1 | 7000-0019-12-160 | M12 x 160 | - |
| 24 | THREADED BAR - M16x300 | 2 | 7000-0019-16-300 | M16 x 300 | - |
| 25 | TAKE UP BEARING UNIT - 45 mm | 2 | PP-000381-06 | UCST209 | - |
| 26 | GEARED MOTOR | 1 | PP-001406 | NMRVP 110 B14 112 | - |
| 27 | BELT - 750wide/3600crs | 1 | PP-003616 | BLACK RUBBER c/w 50mm FLIGHTS INSET 90mm @ 200mm PITCH | - |

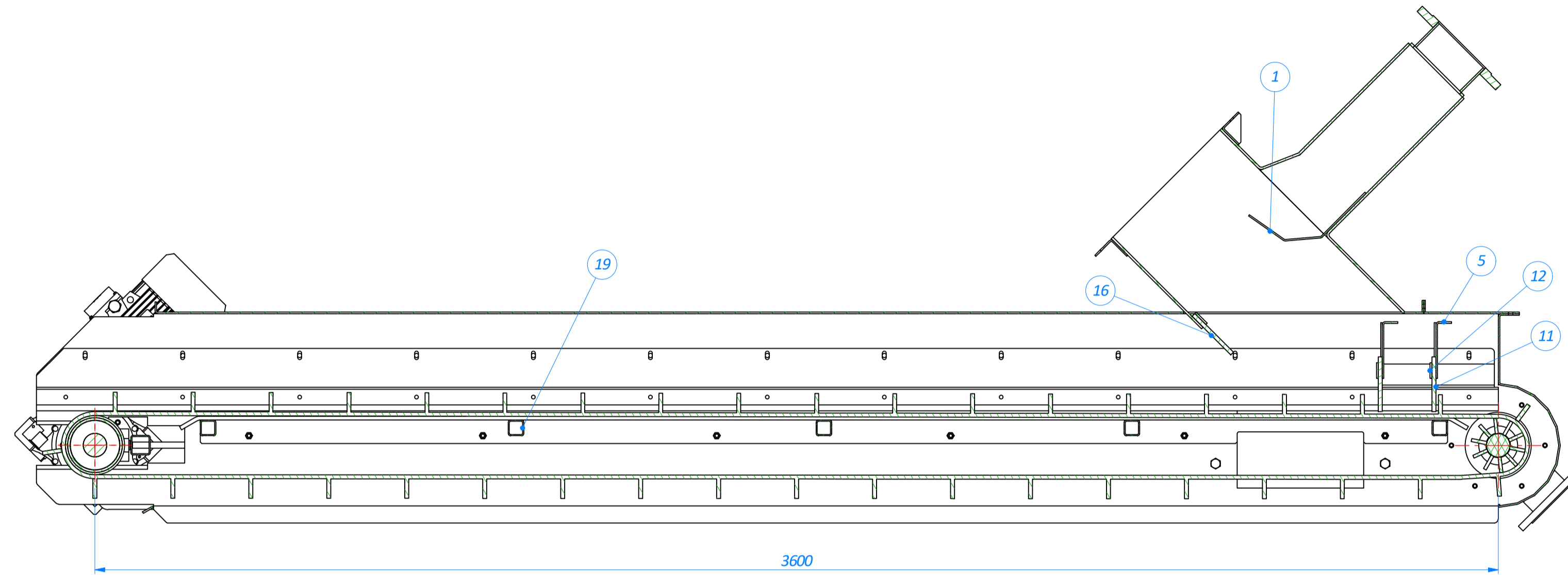

SECTION A-A
SCALE - (1 : 10)

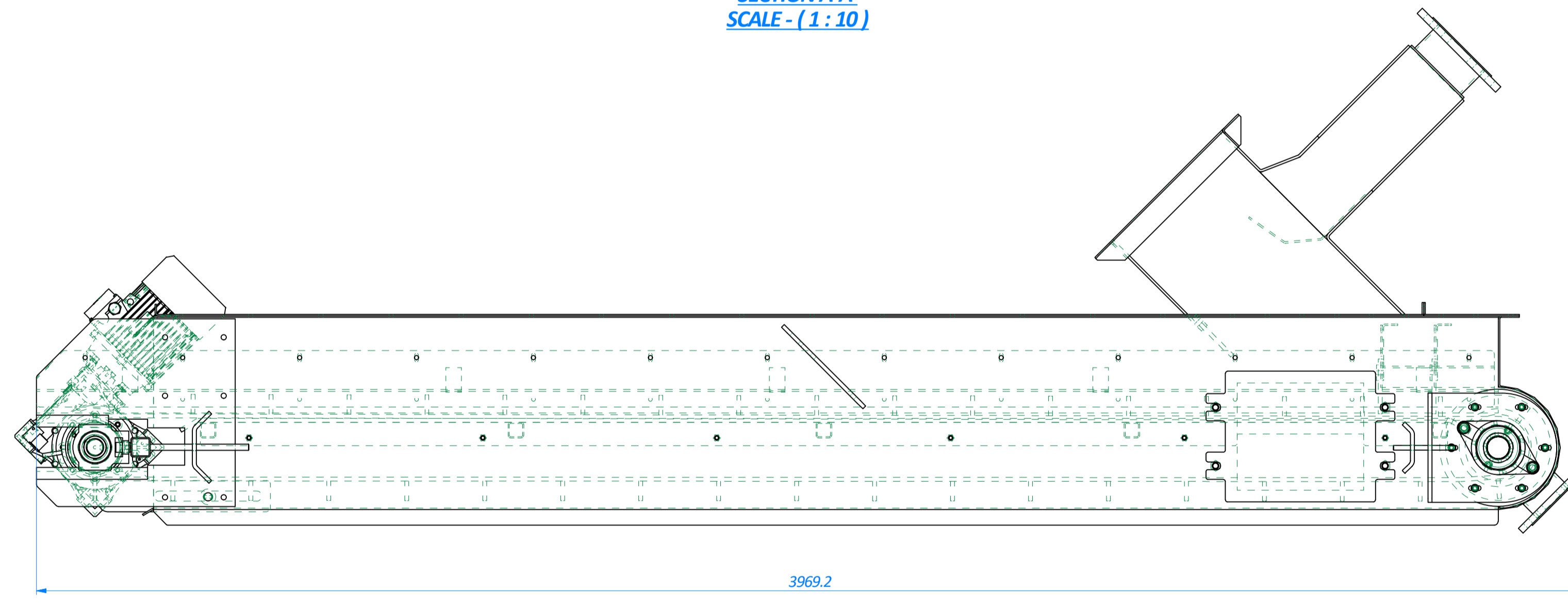

SCALE - (1 : 10)

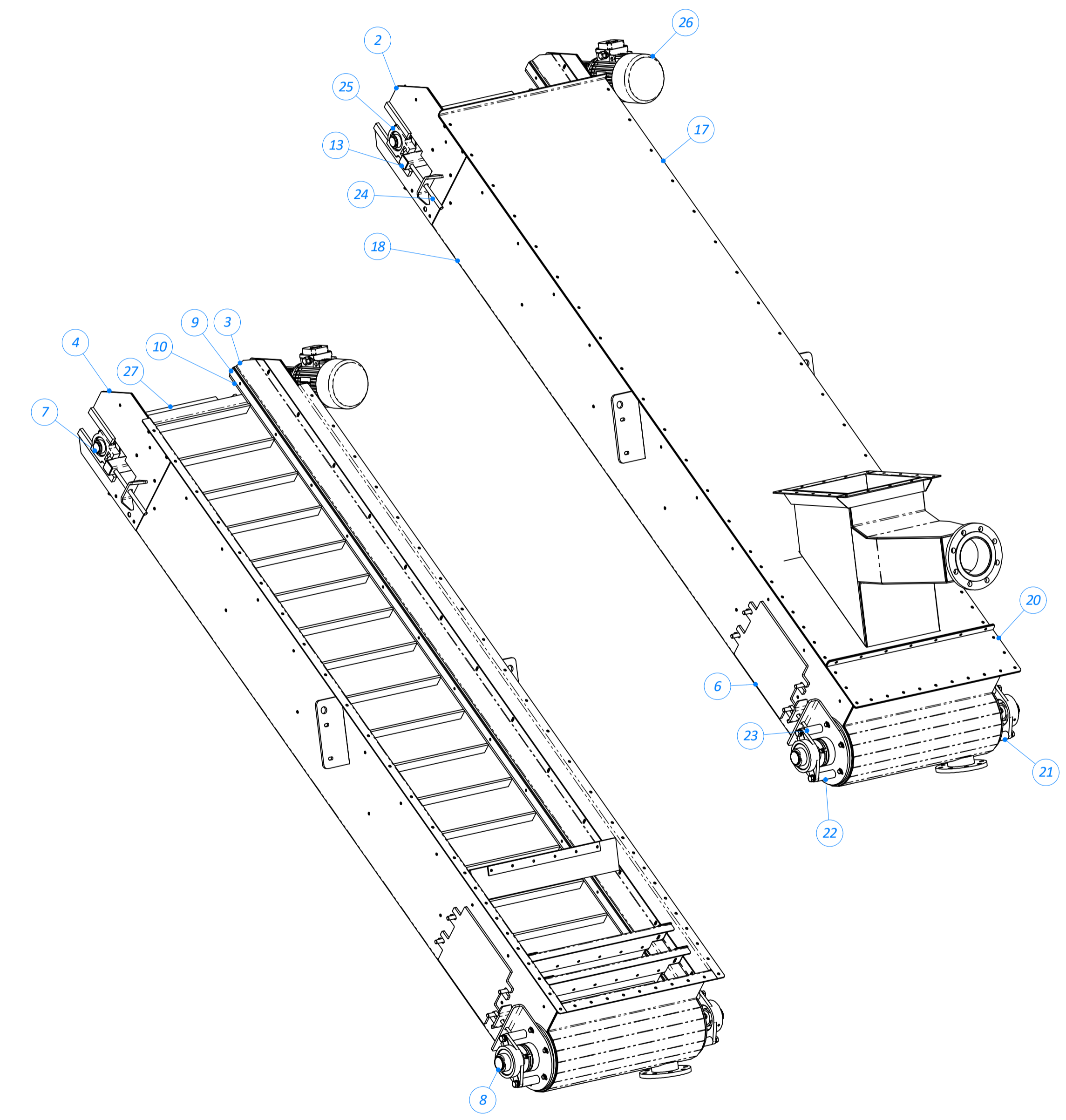
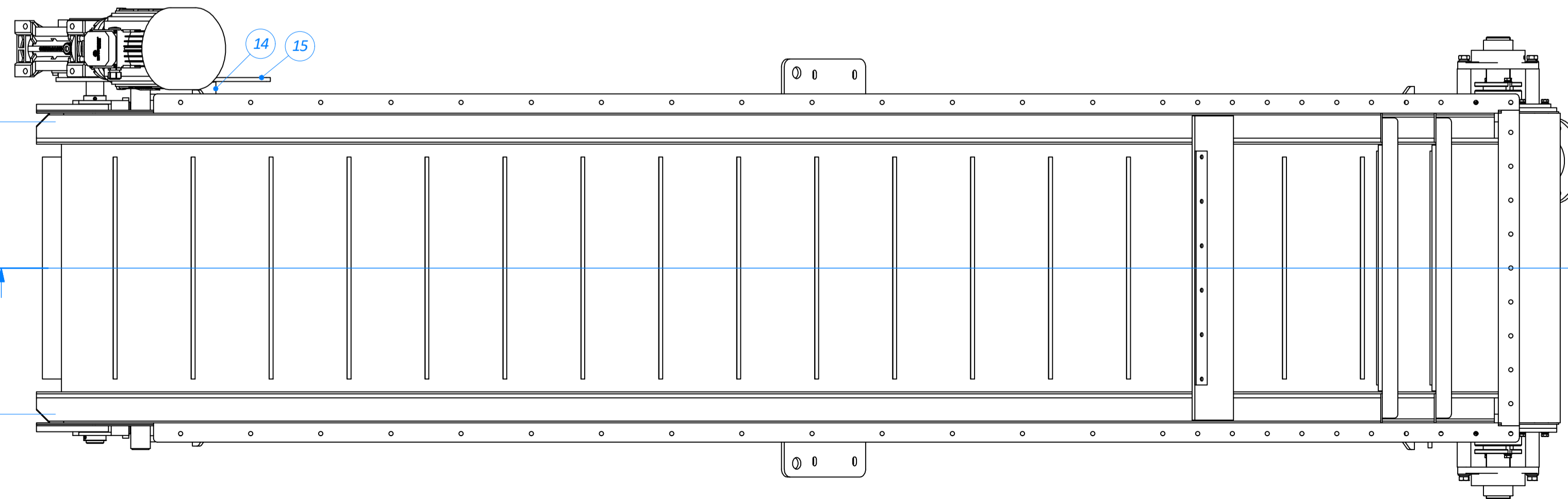

| | | | | |
|--|--|---|---|--------------------------------|
| <p>A Member of the Haith Tickhill Group of companies Cow House Lane, Ambleside, Doncaster, South Yorkshire, England DN3 3EE Tel: +44 (0)1502 831911 Fax: +44 (0)1502 300173 sales@haith.co.uk This drawing is the property and copyright of the Haith Tickhill Group and is supplied on the express condition that it is neither copied nor passed to any third party without prior permission in writing.</p> | <p>UNLESS OTHERWISE SPECIFIED TOLERANCES ON DIMENSIONS ARE:- Whole numbers: +0.1 One Decimal Places: +0.05 Two Decimal Places: +0.01</p> | <p>DRAWING TITLE STONE ELEVATOR ASSEMBLY - 750wide/3600crs</p> | <p>STOCK NUMBER 24141-003-0003</p> | |
| | <p>SCALE A1</p> | <p>DATE 15/05/2017</p> | <p>DESIGNER RJM</p> | <p>REVISION D</p> |
| | <p>PER VIEW 1 of 1</p> | <p>SCALE A1</p> | <p>DATE 15/05/2017</p> | <p>DESIGNER RJM</p> |
| | <p>1 of 1</p> | <p>SCALE A1</p> | <p>DATE 15/05/2017</p> | <p>DESIGNER RJM</p> |