

DEWATERING HYDRAFLOW DATA SHEET

S3VHL 75MM HYDRAULIC SUBMERSIBLE SLUDGE OR SLURRY PUMP

The SPP HYDRAFLOW S3VHL Hydraulic Drive Submersible Pump is designed to pump sludges, slurries and liquids with stringy solids. Uses for this pump include liquid manure pumping, water treatment slurries and clarifier tanks. This versatile pump is offered in aluminum or ductile iron construction.

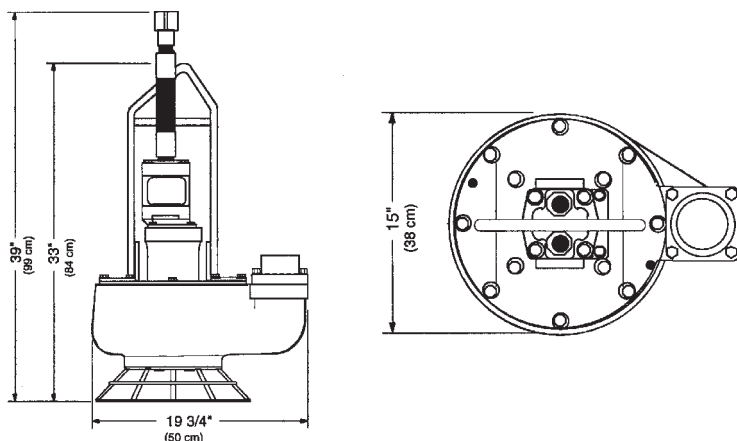

DESIGN FEATURES

- Small overall size allows pump to fit through 500mm diameter opening.
- Fully recessed vortex impeller will pass 75mm semi-solids.
- Lightweight Aluminum and durable Ductile Iron models are standard.
- Variable Speed Hydraulic Drive.
- Oil Lubricated Seals - pump can run dry.
- Can be bolted directly into a pipeline or fitted with a suction hose for vacuuming underwater.
- Safe Hydraulic Drive can be used where electric power is hazardous or impractical.
- Operates with our HT25D, HT35D or HSQ35D Hydraulic Power Units or any open centre power source with output flows to 68 l/m.

DEWATERING

HYDRAFLOW DATA SHEET

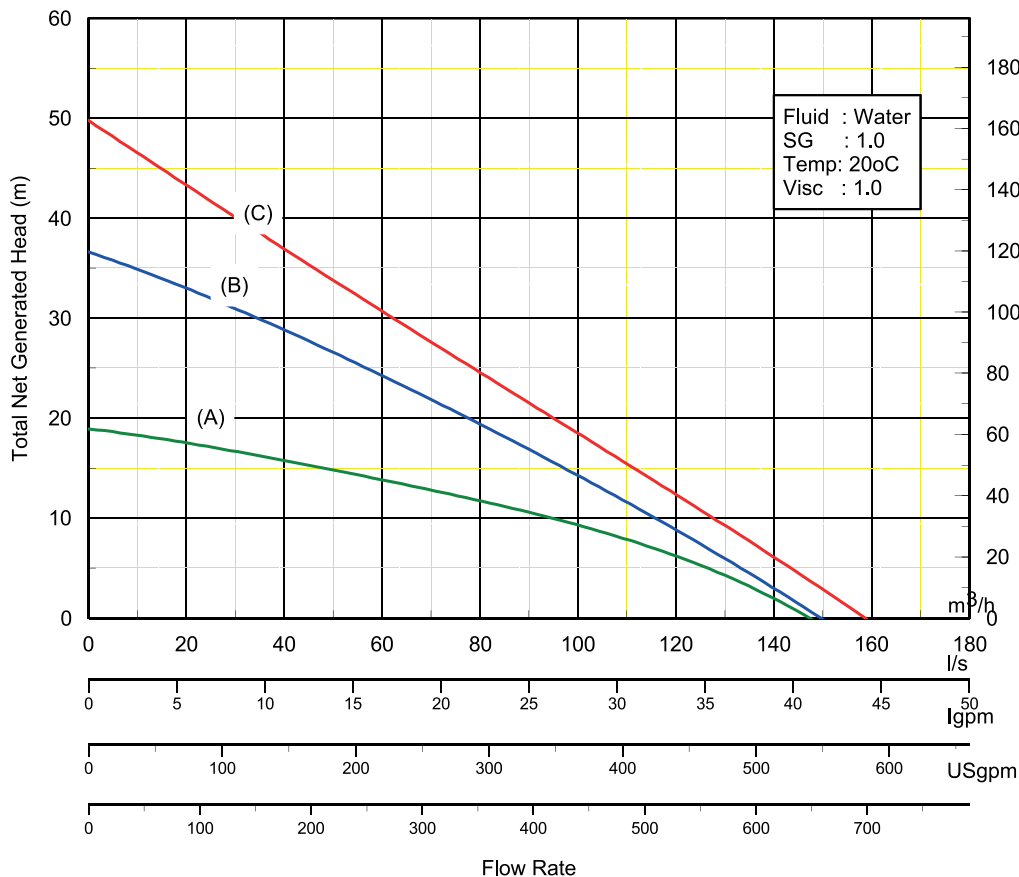

Hydraulic Input: (A) 38 l/m @ 193 bar (B) * 56 l/m @ 179 bar
(C) ** 68 l/m @ 200 bar
* Typical performance with HT25D
** Typical performance with HSQ35

HYDRAULIC SUBMERSIBLE PUMP

PUMP TYPE	S3VHL
BRANCH SIZES	Suction: 80mm x Disch: 80mm
IMPELLER	Vortex
SOLIDS HANDLING	65mm diameter
HYDRAULIC MOTOR	Gear
INPUT - HYDRAULIC FLOW	68 l/m
INPUT - HYDRAULIC PRESSURE	200bar
HYDRAULIC OIL	ISO 46
HYDRAULIC OIL TEMPERATURE	Max 140°F

PUMP SPECIFICATIONS

FLOW RATE
159 m³/h Maximum
DISCHARGE HEAD
50 m Maximum
WEIGHT
DI - 131kg or AL - 70 kg
HEIGHT
840 mm
MAX DIAMETER
500 mm
MAX SOLIDS SIZE
75 mm Diameter
HOSE PORT
1" SAE
SUCTION FLANGE
3" 125# ASA
DISCHARGE PORT
3" NPT F
POWER SOURCE
HT25D, HT35D or HSQ35D
PUMP CASING
Ductile Iron or HT Aluminium
IMPELLER
Ductile Iron
WEAR RING &/OR PLATE
Stainless Steel
SHAFT
Stainless Steel
SHAFT SEAL - STANDARD
Carbon Ceramic
ALTERNATIVE SEAL
Silicon Carbide
ELASTOMERS - STANDARD
Buna (N)
HYDRAULIC OIL
214-320 s.s.u. @ 64 Deg. C
INPUT FLOW
68 l/m Maximum
OPERATING PRESSURE
200 bar Maximum